



Ron Hopkinson

*Coachwork and Finishing Specialists
MGB and TR Spares Stockists*

1102 London Road, Alvaston, Derby.

Telephone: Derby (0332) 72721

THE MGB PARTS CATALOGUE

224.13

Sys. nr. 14168

CREDIT CARDS WELCOME

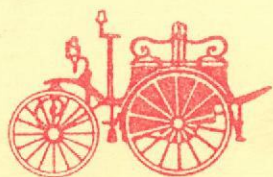

Dansk Veteranbil Klub

CONTENTS

ENGINE (-64)	3	Link	36
ENGINE(64-)		King Pin	36
Block	4	Wheel Bearing	37
Bottom End	4	PROP SHAFT	38
Flywheel,Cam,Timing	6	REAR AXLE &	
Cylinder Head	9	REAR SUSPENSION	
Gaskets & Seals	10	Banjo Axle	39
Oil pump & valve	10	Tube type Axle	39
ENGINE-EXTERNAL-		Rear Spring etc.	40
MGB, C, & V8		Shock Abs., etc.	41
Oil Filter & parts	11	HYDRAULICS	
Water pump & Fan	11	Clutch	42
Oil-cooler & breather	12	M./Cyl Rods	
Mounting	12	& Pedals	42
Clutch	13	Brake M./Cyl. &	
ENGINE - V8		Lamp Switch	42
Internal	14	Brake Hoses & Pipes	43
Cylinder Heads	15	Front Brakes	43
Gaskets & Seals	15	Rear Brakes	44
ENGINE - MGC		Handbrake	46
Internal	16	Servo	46
Cylinder Head	17	ELECTRICAL, INSTRUMENTS	
Gaskets & Seals	17	ETC.	
GEARBOX		Ignition	47
-68	18	Battery	48
68-	19	Dynamo, Alternator	
Ancillaries	21	Starter, Fuses	49
COOLING & HEATER		Battery, Cables	50
Cooling	22	Switches	50
Radiator Hoses	22	Column Switches &	
Heater	23	Flasher Units	51
FUEL SYSTEM		Front Lamps	51
Tank, Pipes & Pump	24	Rear Lamps	53
Carb. Controls	25	Interior Lamp	53
Carb. & Air Filter	25	Bulbs	53
EXHAUST		Windscreen Wipers	54
System & Pipes	28	Speedometer & Cables	54
Fittings	28	Tachometer, other	
STEERING		gauges & volt.stab.	55
Steering Rack	31	WELDED PANELS	
Steering Column	31	Rear Panel & Rear	
FRONT SUSPENSION		Wing	56
Shock Abs. & Spring	34	Sills	56
Wishbone & Bump Stop	34	Inner Wheel Arches	
Anti-Roll Bar	36	& Floors	58

Radiator Ducting	59	Liners - others	83
Chassis	59	Carpets & Mats - Black	84
BOLTED PANELS		Carpets & Mats - Red	86
Front Valance & spoilers	60	Carpets & Mats	
Finishers: Wing, Door, & Roof	60	Autumn Leaf	86
Front Wing	61	Carpets & Mats - Navy Blue	86
Door	62	Carpets & Mats - Yellow Ochre	86
Door Handles & Locks	63	Seats, Belts & Headrests	87
Drop Glass etc.	64	WHEELS & TOWBAR	
Quarter Lights	65	Wheels	88
Bonnet	66	Wheel Accessories etc.	88
Boot Lid & Tailgate	68	Towbar	89
Badges: Boot Lid & Tailgate	68	LITERATURE & ACCESSORIES	
SOFT TOP, TONNEAU HARDTOP		Literature	90
Soft top & Fittings	70	Paint	90
Tonneau & Hardtop	70	Accessories	90
GRILLE, BUMPERS		INFORMATION	91
Grille	72	ABBREVIATIONS	92
Front Chrome Bumper	72		
Rear Chrome Bumper	74		
Rubber Bumper	74		
Number Plate	74		
WINDSCREEN, WINDSCREEN WASHER & MIRRORS			
Windscreens etc.	76		
W/Screen Washer	76		
Mirrors	78		
INTERIOR TRIMMING			
Fascia & Console	79		
Trim Fixings	79		
Draught Excluder	89		
Door Trim (Excluding Liners)	80		
Liners - Black	82		
Liners - Autumn Leaf	82		
Liners - Navy Blue	83		
Liners - Yellow Ochre	83		

ENGINE 18G/GA (3BEARING) (-64)

B4AA Pistons
B4BA Piston Rings
B6AA Crankshaft
B6BA Con Rod -Nos. 1 & 3
B6BB Con Rod -Nos. 2 & 4
B8AA Flywheel Lock Washer
B14AA Timing Cover Gasket
B16AA Tachometer Pinion
B18AA Sump Gasket
B18AB Conversion Set
B18BA Oil Pump
B18BB Oil Pump Kit
B18BC Oil Pump Gasket

ENGINE 18GB/GD/GG/V (5 - BEARING) 1964 -

BLOCK

B26AA Cylinder Block

B26BA Short Engine

B26BB Full Engine

B28AA Core Plug

B30AA Camshaft Bearing

B32AA Piston - 4Rings - STD

B32AB Piston - 4Rings - 020

B32AC Piston - 4Rings - 040

B32BA Piston - 3Rings - STD

B32BB Piston - 3Rings - 020

B32BC Piston - 3Rings - 040

B32BD Piston - 3Rings - 060

B32CA Piston Rings(4) STD

B32CB Piston Rings(4) 020

B32CC Piston Rings(4) 040

B32DA Piston Rings(3) STD

B32DB Piston Rings(3) 020

B32DC Piston Rings(3) 040

BOTTOM END

B34AA Con Rod

B34AB Tab Washer - Big End

B34BA Con Rod Bolt (-70)

B34BB Con Rod Bolt (70-76)

B34BC Con Rod Bolt (76-)

B34BD Con Rod Nut (70-)

B36AA Big End Brgs STD

B36AB Big End Brgs 010

B36AC Big End Brgs 020

B36AD Big End Brgs 030

B36AE Big End Brgs 040

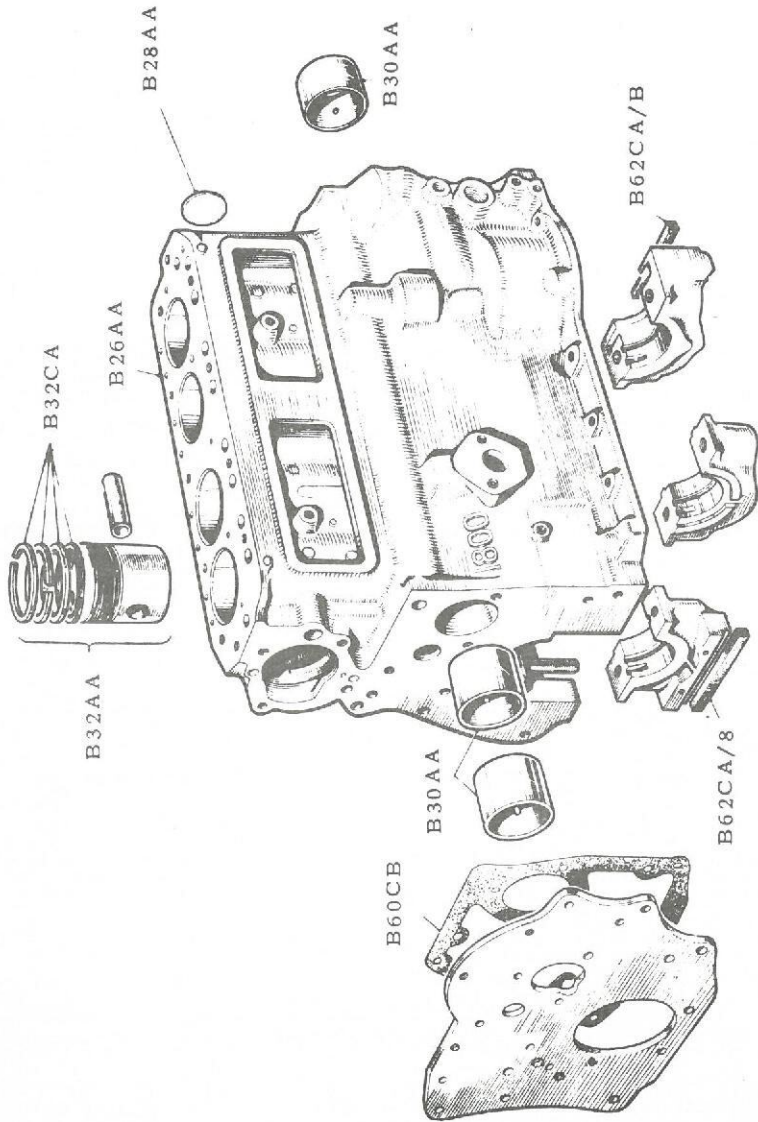

B36BA Main Brgs STD
B36BB Main Brgs 010
B36BC Main Brgs 020
B36BD Main Brgs 030
B36BE Main Brgs 040

B36CA Thrust Washers STD
B36CB Thrust Washers 003
B36CC Thrust Washers 005

B36DA Crankshaft (-76)
B36DB Crankshaft (76-)

B38AA Bush - Crank (-76)
B38AB Bush - Crank (76-)
B38AC Bush - Crank - Bronze (76-)

B40AA Woodruff Key (-18GG)
B40AB Woodruff Key (18V-)

B40BA Crank Pulley Lock Tab (-76)
B40BB Crank Pulley Lock Tab (76-)
B40BC Crank Pulley

FLYWHEEL, CAM, VALVE TIMING

B42AA Flywheel
B42AB Starter Ring Gear (-68)
B42AC Starter Ring Gear (68-)

B42BA Flywheel Bolt
B42BB F/Wheel Lock Washer

B44AA Camshaft

B44BA Timing Chain Duplex
B44BB Timing Chain - Single
B44BC Sprocket

B46AA T/Chain Tensioner

B46BA Tensioner Tab Washer
B46BB Tensioner Kit
B46BC Tensioner Slipper Head

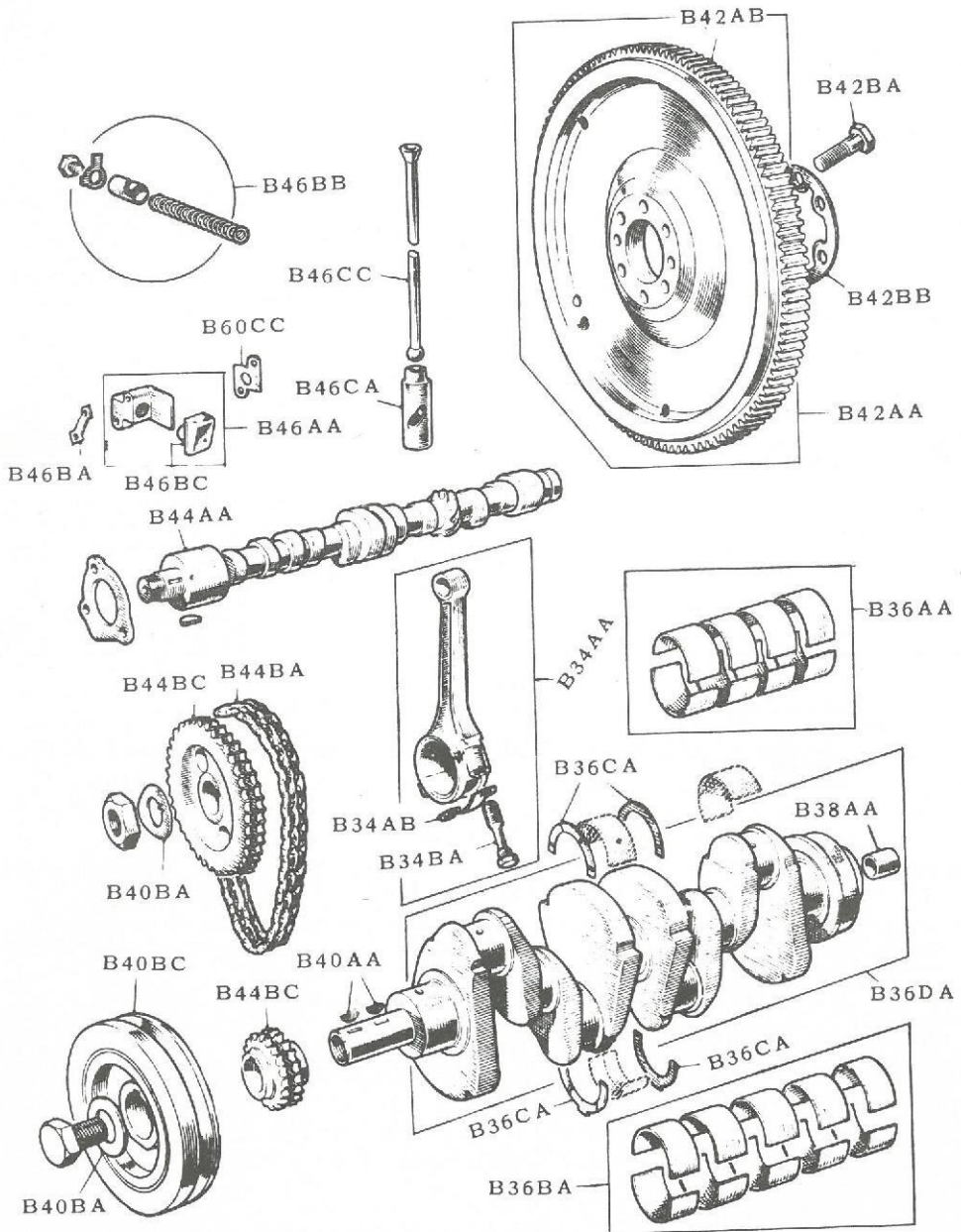

B46CA Tappet (Cam Follower) - 18GG

B46CB Tappet (Cam Follower) 18V

B46CC Pushrod

B46DA Tab Washer - Backplate

B46DB Tab Washer - Backplate

B46DC Tab Washer - Backplate

B46DD Tab Washer - Oil Seal

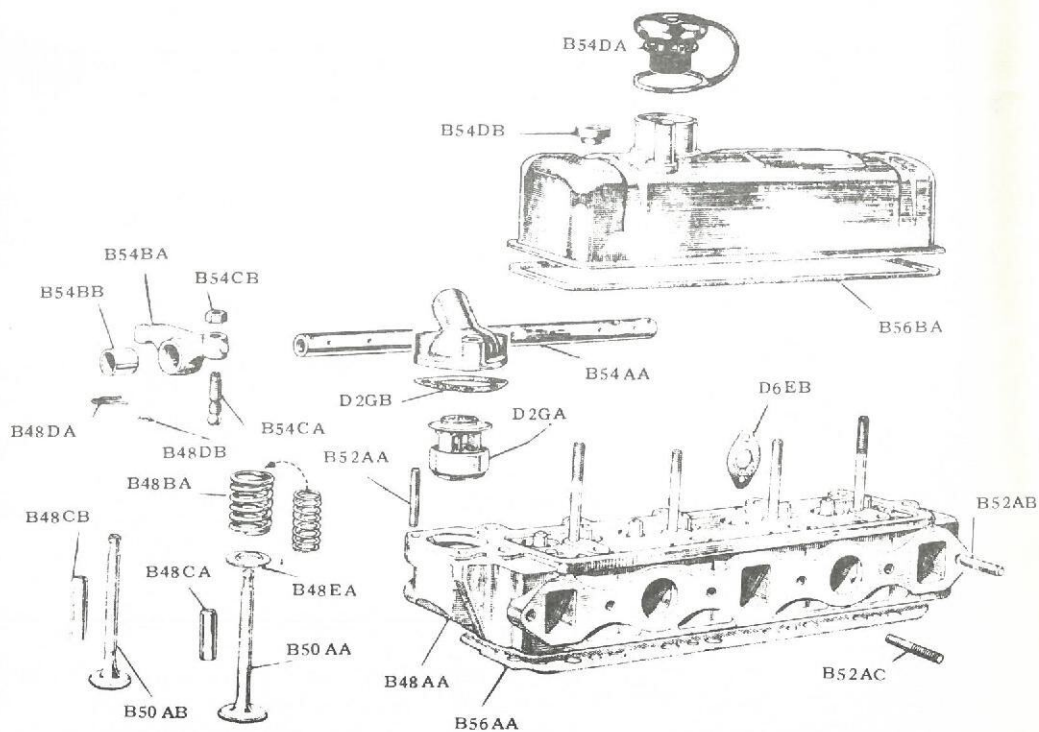

CYLINDER HEAD

- B48AA Cyl. Head
- B48AB Cyl. Head Complete

- B48BA Valve Springs Double
- B48BB Valve Springs Single

- B48CA Valve Guide - Inlet
- B48CB Valve Guide - Exhaust

- B48DA Valve Cotter Circlip
- B48DB Valve Rubber Ring

- B48EA Valve Spring Collar

- B50AA Valve - Inlet - 18GB
- B50AB Valve - Exhaust - 18GB

- B50BA Valve - Inlet 18GD - 18GG
- B50BB Valve - Inlet 18V (-76)

- B50CA Valve - Inlet 18V (76-)
- B50CB Valve - Exhaust 18GD -

- B50DA Valve Seat Insert - Inlet
- B50DB Valve Seat Insert - Inlet (72 - 76)
- B50DC Valve Seat Insert - Exhaust

- B52AA Stud - Thermostat Cover
- B52AB Stud - Man/Head Outer
- B52AC Stud - Man/Head Inner
- B52AD Stud - Manifold Outlet

- B54AA Rocker Shaft
- B54AB Rocker Shaft Assy.

- B54BA Valve Rocker Arm
- B54BB Valve Rocker Bush

- B54CA Valve Rocker Screw
- B54CB Valve Rocker Nut

- B54DA Oil Filler Cap
- B54DB Rocker Cover Rubber Bush

GASKETS & SEALS

B56AA Cylinder Head Gasket
B56AB Cylinder Head Set

B56BA Rocker Cover Gasket

B56CA Manifold Gasket

B60AA Timing Cover Oil Seal
B60AB Crank Rear Oil Seal

B60BA Side Cover Gasket - Cork
B60BB Side Cover Gasket - Rubber

B60CA Timing Cover Gasket
B60CB Eng. Mounting-G Plate Gasket
B60CC T/Chain Tensioner Gasket

B60DA G/Box Mtg. Plate Gasket
B60DB G/Box Mtg. Plate Gskt. Upper

B62AA Oil Pump To Block Gasket
B62AB Oil Pump To Strainer Gasket

B62BA Drain Plug Washer

B62CA Main Brg. Cap Cork-Thick
B62CB Main Brg. Cap Cork - Thin

B62DA Sump Gasket
B62DB Conversion Set

(64-) OIL PUMP & RELIEF VALVE

B64AA Oil Pump
B64AB Oil Pump Kit

B64BA Oil Press Relief Valve
B64BB Oil Relief Spring
B64BC Oil Relief Packing
B64BD Oil Relief Washer

ENGINE -EXTERNAL PARTS - MGB C & V8

OIL FILTER & PARTS

B72AA Oil Filter - Paper
B72AB Oil Filter-Large Cannister
B72AC Oil Filter - Small Cannister

B72BA Oil Filter - MGC

B72CA Filter Head
B72CB Filter Head (No Spillage)
B72CC Filter Head Bolt
B72CD Sealing Washer

B72DA Filter Head - V8

WATER PUMP & FAN

B74AA Water Pump 18G/GA

B74BA Water Pump 18GB/GD/GG

B74BB Water Pump 18V (-75)

B74CA Water Pump 18V (75-)

B74DA Fan Fixing Grommet

B74DB Water Pump Gasket

B74EA Water Pump - V8

B74EB Water Pump Gasket - V8

B74FA Water Pump - MGC

B74FB Water Pump Gasket - MGC

B80AA Fan Belt (-75)

B80AB Fan Belt (75-)

B80BA Fan Belt - V8

B80CA Fan Belt - MGC

B82AA Fan (-75)
B82AB Fan (75-76)
B82AC Fan (76-) & V8

B82BA Fan - MGC

OIL - COOLER & BREATHER

B84AA Oil Cooler (-75) & MGC
B84AB Oil Cooler Pipes

B84BA Oil Cooler (75-)

B84CA Oil Cooler-V8

B92AA Valve Assembly - Breather - 18GD
B92AB Breather Diaphragm - 18GD

B92BA Y - 0 Y- Piece - Breather 18GG-

B92CA Hose - Eng. To Y-Piece
B92CB Hose-Y-Pce. to Front Carb.
B92CC Hose-Y-Pce. To Rear Carb.

MOUNTINGS

B98AA Eng. Mounting - Front - RH (-75)
B98AB Eng. Mounting - Front - LH (-75)

B98BA Eng. Mounting - Front (75-)

B98CA Eng. Mounting - Front - V8

B98DA Eng. Mounting - Front - MG C

B100AA G/Box MTG. GT.(68-) & Roadster
B100AB G/Box MTG. GT.(-67)

B100BA G/Box Steady Buffer
B100BB G/Box Rear Bush Roadster (-68)
B100BC G/Box Rear Bush Roadster (68-) & GT

B100CA G/Box MTG. - MGC

CLUTCH

B 102AA Clutch Cover Plate
B 102AB Clutch Friction Plate
B 102AC Release Bearing

B 102BA Clutch Cover Plate - V8
B 102BB Clutch Friction Plate - V8
B 102BC Release Bearing - V8

B 102CA Clutch Cover Plate - MGC
B 102CB Clutch Friction Plate - MGC
B 102CC Release Bearing - MGC

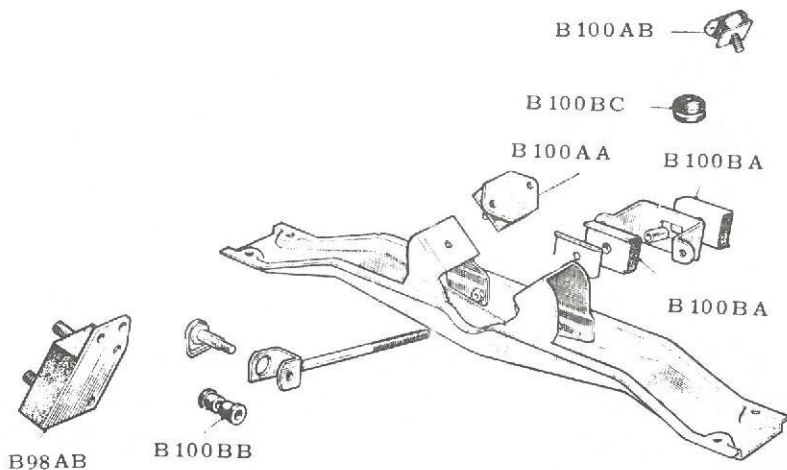

ENGINE - V8

INTERNAL

B103AA Engine - V8

B104AA Piston Set - STD

B104AB Piston Set -.010

B104AC Piston Set -.020

B104BA Piston Ring Set - STD

B104BB Piston Ring Set -.010

B104BC Piston Ring Set -.020

B104CA Big End Bearings - STD

B104CB Big End Bearings -.010

B104CC Big End Bearings -.020

B104CD Big End Bearings -.030

B104CE Big End Bearings -.040

B104DA Main Bearings - STD

B104DB Main Bearings -.010

B104DC Main Bearings -.020

B104DD Main Bearings -.030

B104DE Main Bearings -.040

B106AA Crank - 1st Motion Shaft Bush

B106BA Camshaft

B106BB Tappet - Hydraulic

B106BC Pushrod

B106CA Timing Chain

B106DA Gear & Shaft - Oil Pump

B106DB Gear - Oil Pump

B106DC Cover - Oil Pump

CYLINDER HEADS

B110AA Cylinder Head - RH
B110AB Cylinder Head - LH

B112AA Valve Spring Set
B112AB Valve Guide

B112BA Valve - Inlet
B112BB Valve - Exhaust

B112CA Rocker Shaft
B112CB Rocker Arm - RH
B112CC Rocker Arm - LH

B112DA 'O' Ring - Oil Filler Cap
B112DB Retainer - HT Lead
B112DC Retainer - HT Lead - RH

B116AA Exhaust Manifold - RH
B116AB Exhaust Manifold - LH
B116AC Exhaust Manifold Gasket

B118AA Thermostatic Fan Switch
B118AB Switch Gasket

GASKETS & SEALS

B120AA Head Set
B120AB Conversion Set

B120BA Head Gasket
B120BB Rocker Cover Gasket
B120BC Front Cover Gasket

B120CA Sump Gasket
B120CB Inlet Manifold Gasket
B120CC End Seal - Inlet Gasket

B120DA Rear Oil Seal
B120DB Packing

ENGINE — MGC

INTERNAL

B126AA Engine

B126BA Core Plug — Large

B126BB Core Plug — Small

B126CA Camshaft Liner Set

B126DA Pistons

B126EA Piston Rings

B128AA Big End Bearings

B128BA Main Bearings

B128CA Thrust Washers

B128DA Lock Washer — Crank Pulley

B128DB Flywheel Lock Washer

B128DC Timing Chain Tensioner Kit

B128DD Timing Chain Slipper Head

B128DE Timing Chain Tensioner Lock Washer

B128EA Camshaft

B128EB Tappet

B128EC Timing Chain

B128ED Lock Washer — Timing Wheel

B128FA Oil Pump

CYLINDER HEAD

B130AA Cylinder Head

B130BA Valve Spring Set

B130BB Valve Guide - Inlet

B130BC Valve Guide - Exhaust

B130CA Valve - Inlet

B130CB Valve - Exhaust

B130DA Rocker Shaft

B130DB Rocker

GASKETS

B134AA Head Set

B134AB Conversion Set

B134BA Head Gasket

B134BB Rocker Cover Gasket

B134CA Sump Gasket

B134CB Manifold Gasket

GEARBOX

(-68) NO SYNCHRO IN 1st GEAR

C2AA Gearbox - Non O/D

C2AB Gearbox - O/D Type

C2BA Oil Seal - 1st Mot. Shaft

C2BB Gasket - Front Cover

C2CA Gasket - Side Cover

C2CB Gasket - Main Case To Rear

C2CC Gasket - Rear Side - Non O/D

C2DA Oil Seal - Rear - Non O/D

C2DB Oil Seal - Rear - O/D

C2EA Needle Roller 1st Mot. Shaft

C4AA Speedo Pinion

C6AA Layshaft (Early)

C6AB Layshaft Bearing (Early)

C6BA Layshaft (Late)

C6BB Layshaft Bearing (Late)

C6CA Thrust Washer - Front

C6CB Thrust Washer - Rear .155

C6CC Thrust Washer - Rear .157

C6CD Thrust Washer - Rear .160

C6CE Thrust Washer - Rear .163

C6DA Thrust Washer - Front

C6DB Thrust Washer - Rear .155

C6DC Thrust Washer - Rear .157

C6DD Thrust Washer - Rear .160

C6DE Thrust Washer - Rear .163

C8AA Baulk Ring - 2nd (Early)

C8AB Baulk Ring - 2nd (Late)

C8AC Baulk Ring - 3rd & 4th

C8BA Overdrive

C8BB Overdrive Solenoid

SYNCHRO IN 1st GEAR (-68)

C12AA Gearbox - Non O/D
C12AB Gearbox - O/D

C12BA Gearbox - V8

C12CA Gearbox - MGC

C12DA Oil Seal - 1st Mot. Shaft
C12DB Gasket - Front Cover

C12EA Gasket - Side Cover
C12EB Gasket - Remote Housing

C12FA Gasket - Box To Rear - Non O/D
C12FB Gasket - Box To Rear - O/D
C12FC Gasket - O/D To Gearbox

C12GA Gasket - O/D To Gearbox - V8

C14AA Oil Seal - Rear - Non O/D
C14AB Oil Seal - Rear - O/D

C14BA Bearing - 1st Mot. Shaft

C14CA Layshaft
C14CB Bearing - Layshaft

C14DA Thrust Washer - Front
C14DB Thrust Washer - Rear
C14DC Thrust Washer - Rear
C14DD Thrust Washer - Rear
C14DE Thrust Washer - Rear

C14EA Thrust Washer - Front
C14EB Thrust Washer - Rear
C14EC Thrust Washer - Rear
C14ED Thrust Washer - Rear
C14EE Thrust Washer - Rear

C14FA Laygear - V8
C14FB 1st Motion Shaft - V8

C16AA Baulk Ring - 1st & 2nd
C16AB Baulk Ring - 3rd & 4th

C16BA Tab Washer - 1st Mot. Shaft
C16BB Tab Washer - Mainshaft Front
C16BC Tab Washer - Mainshaft Rear - Non O/D
C16BD Tab Washer - Mainshaft Rear - O/D

C20AA Speedo Pinion - Early Non O/D
C20AB Speedo Pinion - Late Non O/D

C20BA Speedo Pinion - Early O/D
C20BB Speedo Pinion - Late O/D

C20CA Overdrive
C20CB Overdrive - Solenoid

C20DA Overdrive - V8

C20EA Overdrive - MGC

C20FA Solenoid 'O' Ring
C20FB Solenoid 'O' Ring
C20FC Solenoid 'O' Ring
C20FD Solenoid Ball
C20FE Solenoid Gasket

C20GA O/D Filter & Gasket

C22AA Relief Valve 'O' Ring
C22AB Filter - Relief Valve
C22AC 'O' Ring - Relief Valve
C22AD Washer - Relief Valve

C22BA Relief Valve

C22CA Relief Valve - V8

C22DA Relief Valve - MGC

C24AA O/D Thrust Washer

ANCILLARIES

- C30AA O/D & Reverse Switch
- C30BA Gaiter - Clutch Lever
- C38AA Speedo Angle Drive
- C38AB Speedo Angle Drive (Export)
- C46AA Gear Lever Gaiter (-68)
- C46AB Gear Lever Gaiter (68-)
- C46BA Gear Knob - MG - Leather
- C46BB Gear Knob - MG - Wood
- C46CA Gear Knob (1973-)
- C46DA Gear Lever (1976-)
- C46DB Gear Knob (1976-)
- C46DC Gear Knob Cap (1976-) Non O/D
- C46EA Gear Knob Cap With O/D Switch (1976 -)
- C46EB Overdrive Switch (1976 -)
- C46FA Locking Cone - Knob (1976 -)
- C46FB Nut - Knob Retaining (1976 -)
- C46GA Gear Lever Bush (Plastic)

COOLING & HEATER

COOLING

- D2AA Radiator (-1968)
- D2AB Radiator (1968-76)
- D2AC Radiator (1976-)

- D2BA Radiator - V8 (-1975)
- D2BB Radiator - V8 (1975-)

- D2CA Radiator - MGC

- D2DA Radiator Cap (-1968)
- D2DB Radiator Cap (1968-76)
- D2DC Radiator Cap (1976-)

- D2EA Radiator Cap - V8

- D2FA Rad. Filler Plug (76-) & V8
- D2FB Plug Sealing Ring
- D2FC Overflow Pipe

- D2GA Thermostat
- D2GB Thermostat Gasket

- D2HA Thermostat Gasket - V8

- D2JA Thermostat Gasket - MGC

- D2KA Thermostatic Fan Switch (1976-)
- D2KB Sealing Bush - Switch (1976-)
- D2KC Fan Motor (1976-)
- D2KD Fan - See B82AC

RADIATOR HOSES

- D4AA Jubilee Clips (Large)
- D4AB Jubilee Clips (Small)

- D4BA Top Hose (-76)
- D4BA Bottom Hose (-71)
- D4BB Bottom Connector (-71)
- D4BC Bottom Hose (1971-76)

D4CA Top Hose (1976-)
D4CB Bottom Hose (1976-)

D4DA Top Hose - V8
D4DB Bottom Hose - V8

D4EA Top Hose - MGC
D4EB Bottom Hose - MGC

HEATER

D6AA Heater Hose - Straight
D6BA Heater Hose - Shaped

D6CA Hose - Heater to Tube - V8
D6CB Hose - Heater to Valve - V8

D6DA Hose - Long - MGC
D6DB Hose to Valve - MGC

D6EA Heater Valve
D6EB Heater Valve Gasket

D6FA Heater Valve - V8
D6FB Outlet Pipe Gasket - V8

D6GA Heater Valve - MGC (-68)
D6GB Heater Valve - MGC (68-)

D6HA Heater Cable (To Valve)

D8AA Heater Assy. Complete
D8AB Heater Radiator
D8AC Heater Motor

D8BA Heater Control Knob
D8BB Heater Control Mechanism

CARB. CONTROLS

D34AA Accelerator Pedal Rubber (-68)
D34AB Accelerator Pedal Rubber (68-)
D34AC Guide - Accelerator Cable

D34BA Accelerator Cable (-75)
D34BB Accelerator Cable (75-)
D34CA Accelerator Cable - V8 & MGC

D34DA Choke Cable (-68)
D34DB Choke Cable (68-75) & MGC
D34DC Choke Cable (75-)
D34EA Choke Cable - V8

D34FA Carb Linkage Return Springs

CARBURETTER & PARTS

D36AA Front Carb (-68)
D36AB Rear Carb (-68)

D36BA Front Carb (68-73)
D36BB Rear Carb (68-73)

D36CA Front Carb (73-)
D36CB Rear Carb (73-)

D36DA Carb Service Kit (-73)

D38AA Jet Assembly - Front (-73)
D38AB Jet Assembly - Rear (-73)
D38BA Jet Assembly - Front (73-)
D38BB Jet Assembly - Rear (73-)

D38CA Needle - Rich (No5) (-72)
D38CB Needle - STD (FX) (-72)
D38CC Needle - Weak (G2) (-72)
D38DA Needle - (AAU) (72-75)
D38DB Needle - (ACD) (75-)

D38EA Damper
D38EB Spring - Piston - Red

D38FA Jet Assembly - RH - V8
D38FB Jet Assembly - LH - V8

D38GA Needle - (BBU) - V8
D38GB Damper - V8
D38GC Spring - Piston - Yellow - V8

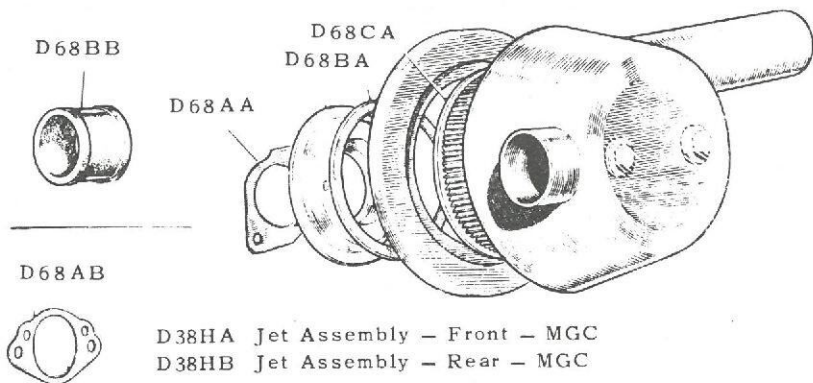

- D38HA Jet Assembly - Front - MGC
 D38HB Jet Assembly - Rear - MGC
 D38JA Needle (ST) - MGC
 D38JB Damper - MGC
 D38JC Spring - Piston - Yellow - MGC
 D40AA Float Needle & Seat
 D40AB Float (-73) & MGC
 D40BA Float Front (73-) & V8
 D40BB Float Rear (73-) & V8

AIR FILTER & GASKETS

- D68AA Gasket - Carb to Manifold
 D68AB Gasket - Carb to Filter Box
 D68AC Gasket Kit (-73)
 D68AD Gasket Kit (73-) & V8
 D68BA Sealing Ring - Air Filter Box
 D68BB Link Tube - Air Filter Box
 D68CA Air Filter
 D68DA Chrome (Pancake) Air Filter
 D70AA Air Filter - V8
 D70BA Gasket - Carb to Air Box - V8 & MGC
 D70BB Hot Air Tube
 D70CA Gasket - Carb Flange - V8 & MGC
 D70DA Flame Trap - V8
 D70DB Hose - Flame Trap to Rocker - V8
 D70DC Hose - Carb to Flame Trap - V8
 D70EA Hose - Vent - Filter - V8
 D70EB Hose - Vent Filter to Crankcase - V8
 D72AA Air Filter - MGC
 D72BA Gasket Kit - MGC

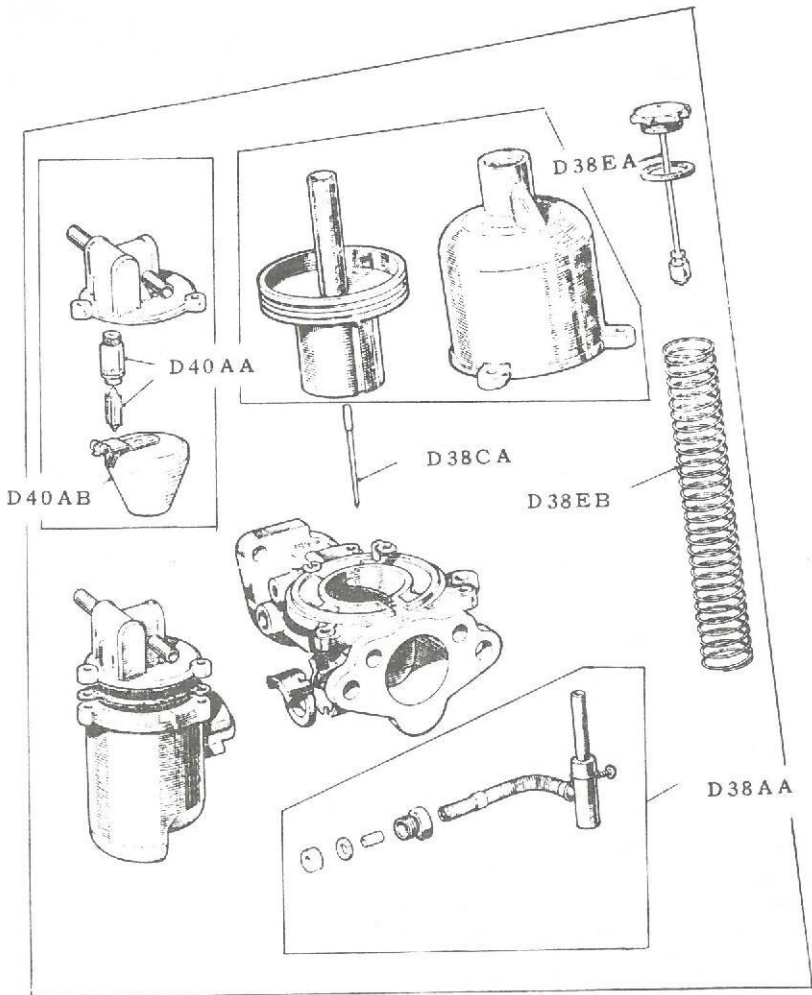

D36AA

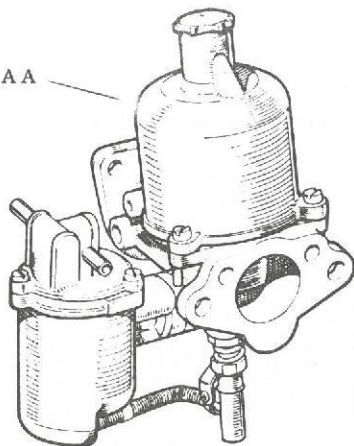

EXHAUST

SYSTEMS & PIPES

- D72AA Exhaust System(-1975)
Genuine
- D72AB Exhaust System(-1975)
Replacement
- D72BA Exhaust System(1975-)
Genuine
- D72BB Exhaust System(1975-)
Replacement
- D72CA Front Pipe(-1975)
- D72CB Front Connecting Pipe
(-1975)
- D72DA Front Silencer Box
(-1975)
- D72DB Rear Connecting Pipe
(-1975)
- D72DC Rear Silencer Box
(-1975)
- D72EA Exhaust Manifold
- D72EB Exhaust Manifold -
Freeflow
- D74AA Exhaust System - V8
(-1975)
- D74AB Exhaust System - V8
(1975-)
- D74BA Front Pipe - MGC
- D74BB Boxes & Tail - MGC

FITTINGS

- D76AA Exhaust Clamp 1 7/8
- D76AB Exhaust Clamp 2 3/8
- D76BA Pipe To Manifold Joint
- D76BB Brass Nuts

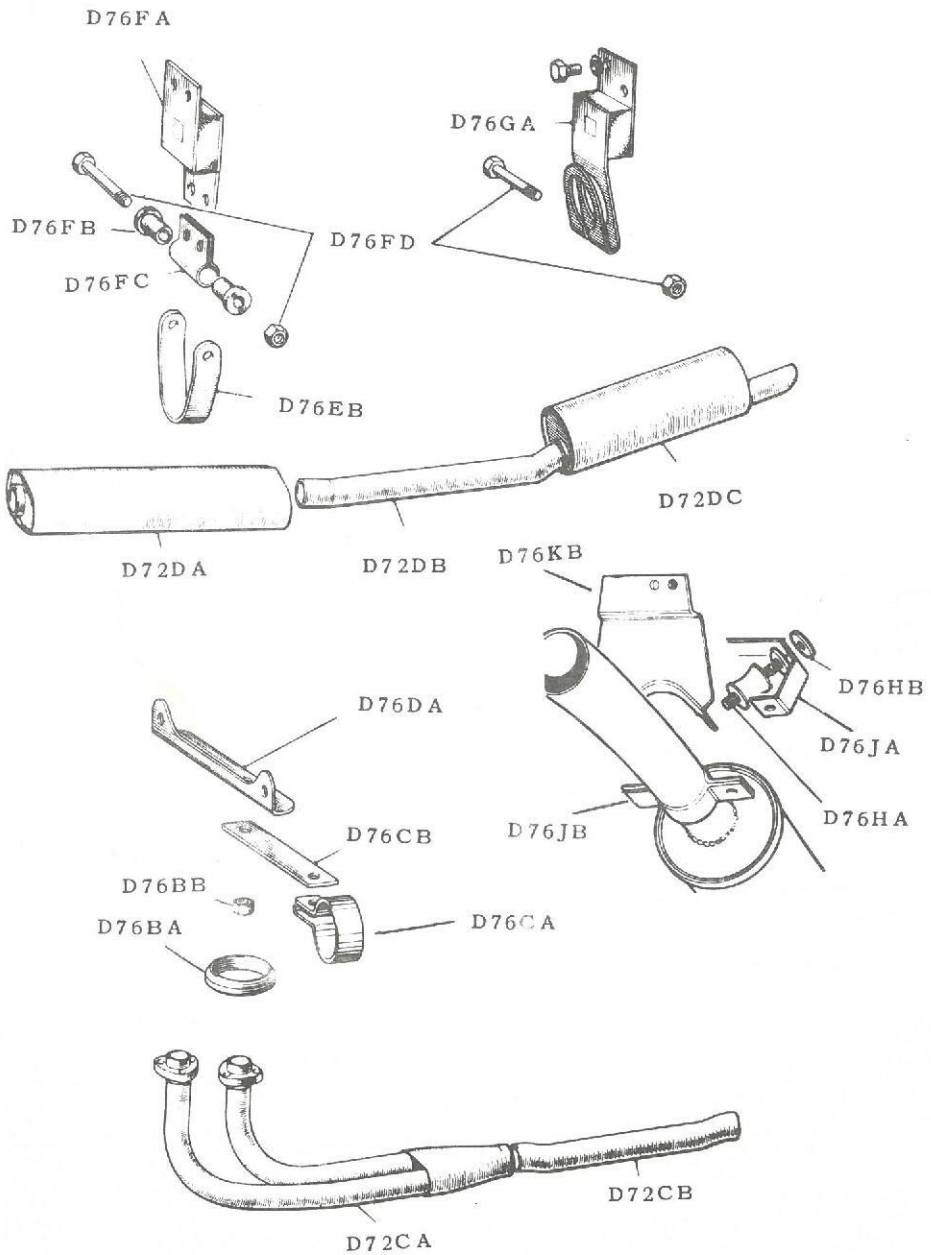

D76CA Front Pipe Clip
D76CB G/Box Mounting Strap

D76DA G/Box Mounting Bracket
(-68)
D76DB G/Box Mounting Bracket
(68-)

D76EA Centre Mounting Kit
D76EB 'U' Bracket

D76FA Centre Mounting
D76FB Tufnel Bush
D76FC Housing Bush
D76FD Bolt & Nut

D76GA Rear Mounting Assembly
(-71)

D76HA Rear Mounting
Bobbin (71-)
D76HB Bobbin Insulating
Washer (71-)

D76JA Rear Hanger Bracket
(71-)
D76JB Saddle Clip (71-)

D76KA Rear Mounting Bracket
(71 - 75)
D76KB Rear Mounting Bracket
(75-)

D78AA Front Pipe Clip - V8
D78AB Rear Saddle Clip-V8
& MGC

D78BA Manifold to Pipe Joint -
MGC
D78BB Front Hanger Bracket - MGC
D78BC Saddle Clip - MGC

STEERING

STEERING RACK & RACK PARTS

- E2AA Steering Rack (-75)
- E2AB Steering Rack (75-)

- E2BA Steering Rack - V8

- E2CA Steering Rack - MGC

- E4AA Steering Rack Gaiter

- E4BA Track Rod Ends

- E4CA Boot - Track Rod Ends
- E4CB Retainer - Boot
- E4CC Spring - Boot

STEERING COLUMN & COLUMN PARTS

- E6AA Bearing - Upper (-73)
- E6AB Bearing - Lower (-73)

- E6BA Bearing - Upper (73-)
- E6BB Bearing - Lower (73-)

- E6CA Steering U/J Assy.(-75)
- E6CB Steering U/J Kit (-75)
- E6CC Steering U/J Assy. (75-)

- E8AA Horn Motif (-70)
- E8AB Horn Motif (1970)

- E8BA Horn Push (71-) Black Centre
- E8BB Horn Push (71-) Gold Centre
- E8BC Horn Push (71-) Red Centre

- E8CA Horn Brush (1971-)
- E8CB Horn Slip Ring (1971-)

- E10AA Steering Wheel - Australi
- E10AB Original Wheel (-70)
- E10AC Original Wheel (70-)

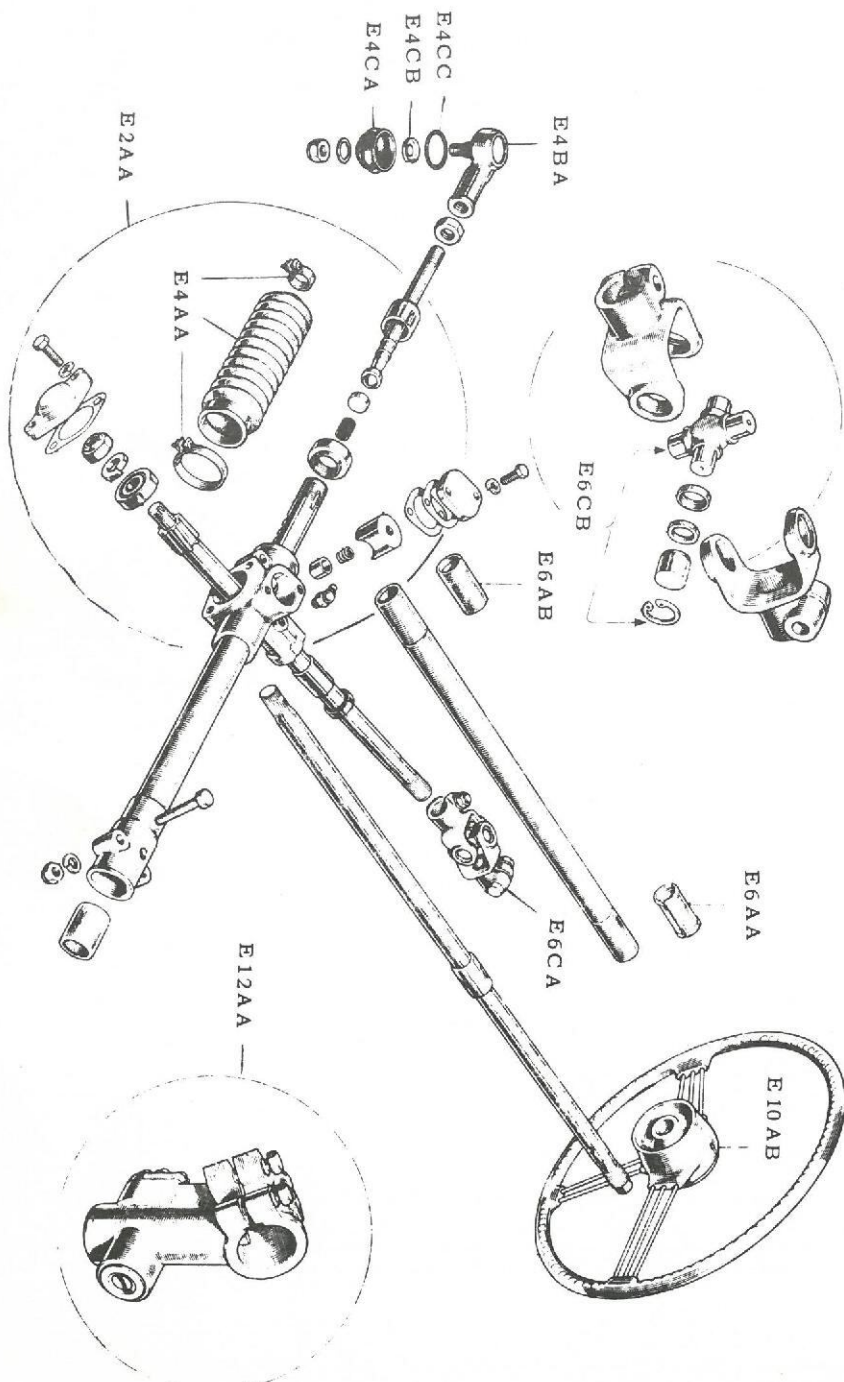

E10BA Astrali Boss Kit (-70)
E10BB Astrali Boss Kit (1970)
E10BC Astrali Boss Kit (71-76)
E10BD Astrali Boss Kit (76-)

E12AA Steering Lock Assy. (-75)
E12AB Switch (-75)
E12AC Shear Bolt (-75)

E12BA Steering Lock Assy. (75-)
E12BB Switch (75-)

FRONT SUSPENSION

FRONT SHOCK ABSORBER & SPRING

- E16AA Crossmember
- E18AA Front Shock Absorber
- E18BA Front Shock Absorber - MGC
- E18CA Rubber Bush - Upper
- E18CB Bolt - Upper
- E18CC Nut - Upper

- E18DA Coil Spring (Roadster -73)
- E18DB Coil Spring (Roadster 73-)

- E18EA Coil Spring (GT -73)
- E18EB Coil Spring (GT 73-75)
- E18EC Coil Spring (GT 75-)

WISHBONE & BUMP STOP

- E20AA Wishbone Arm - Plain
- E20AB Wishbone Arm - For A/Roll Bar - RH
- E20AC Wishbone Arm - For A/Roll Bar - LH

- E20BA Wishbone Inner Bush
- E20BB Bush Retaining Washer
- E20BC Nut

- E20CA Wishbone Inner Bush - Competition Kit

- E20DA Inner Bush - Top Wishbone - MGC
- E20DB Inner Fulchrum Pin - Top Wishbone - MGC
- E20DC Outer Bush - Top Wishbone - MGC
- E20DD Outer Bolt - Top Wishbone - MGC

- E20EA Inner Bush - Lower Wishbone - MGC
- E20EB Front Bush - Tie Rod - MGC
- E20EC Rear Bush - Tie Rod - MGC

- E20FA Bump Rubber
- E20FB Spacer - Bump Rubber

- E20GA Bump Rubber - MGC

ANTI - ROLL BAR

E22AA Anti - Roll Bar - 9/16
E22AB Anti - Roll Bar - 5/8
E22AC Anti - Roll Bar - 3/4

E22BA Link - Anti - Roll Bar - RH
E22BB Link - Anti - Roll Bar - LH

E22CA Link - Anti - Roll Bar -MGC

E22DA Anti - Roll Bar To Link Bush

E22EA Anti - Roll Bar Mounting Bearing (9/16Hole)
E22EB Anti - Roll Bar Mounting Bearing (5/8Hole)

E22FA Anti - Roll Bar Mounting Strap

LINK (LOWER WISHBONE OUTER)

E24AA Link Distance Tube
E24AB Link Kit

E24BA Seal
E24BB Seal Support
E24BC Thrust Washer

E24CA Nut
E24CB Split Pin

E24DA Bolt

E24EA Swivel Pin (Link) Bush

E24FA Bush-Lower Wishbone Outer-MGC
E24FB Swivel Pin-MGC
E24FC Washer-MGC

KING PIN

E26AA Stub Axle (King Pin) Assembly-RH
E26AB Stub Axle (King Pin) Assembly-LH

E26BA King Pin Kit (1Pr.) (Will Split)

E26CA Bottom Dust Excluder Tube
E26CB Top Dust Excluder Tube
E26CC Spring-Dust Excluder

E26DA Grease Nipple Pack
E26DB King Pin Rubber Ring

E26EA Stub Axle (King Pin) Assembly-RH-MGC
E26EB Stub Axle (King Pin) Assembly-LH-MGC

WHEEL BEARING

E28AA Kit-Front Wheel Bearings & Seal

E28BA Bearing-Inner
E28BB Bearing-Outer
E28BC Seal

E28CA Shim-0.003
E28CB Shim-0.005
E28CC Shim-0.010
E28CD Shim-0.030

E28DA Front Hub -Steel Wheel
E28DB Front Hub- Wire Wheel-RH
E28DC Front Hub- Wire Wheel-LH

PROP SHAFT

F 2AA Prop Shaft—Short

F 2AB Prop Shaft—Medium

F 2AC Prop Shaft—Long

F 2BA Universal Joint Kit

F 2BB Prop Shaft Nut

F 2CA Prop Shaft—V8 & MGC

F 2CB Universal Joint Kit V8 & MGC

REAR AXLE & REAR SUSPENSION

BANJO AXLE (EARLY ROADSTER ONLY)

F6AA Axle Assy.
F6AB Differential Unit
F6AC Half Shaft
F6AD Hub

F6BA Hub Oil Seal
F6BB Hub Bearing
F6BC Hub Kit

F6CA Gasket-Shaft To Hub
F6CB 'O' Ring-Shaft To Hub

F6DA Washer-Bearing Retaining Nut
F6DB Gasket-Axle Case
F6DC Oil Seal-Diff.

TUBE TYPE AXLE (LATE ROADSTER & ALL GT)

F12AA Axle Assy.-Steel Wheel
F12AB Axle Assy.-Wire Wheel

F12BA Axle Assy.-V8

F12CA Axle Assy.-Steel Wheel-Non O/D-MGC
F12CB Axle Assy.-Steel Wheel-Overdrive-MGC
F12CC Axle Assy.-Wire Wheel-Non O/D-MGC
F12CD Axle Assy- Wire Wheel-Overdrive-MGC

F12DA Crown Wheel & Pinion-V8

F12EA Distance Collar
F12EB Pinion Thrust Washer

F12FA Axle Case Gasket
F12FB Pinion Oil Seal

F14AA Half Shaft-Steel Wheel
F14AB Half Shaft-Wire Wheel

F14BA Hub (Driving Flange) Steel Wheels
F14BB Hub-Wire Wheel-RH
F14BC Hub-Wire Wheel-LH

F14CA Hub Bearing
F14CB Hub Oil Seal
F14CC Hub Kit

REAR SPRING ETC.

- F 16AA Rear Spring-Roadster (-75)
F 16AB Rear Spring-Roadster (75-)
- F 16BA Rear Spring-GT (-75)
F 16BB Rear Spring-GT (75-)
- F 16CA Rear Spring-V8 (-75)
F 16CB Rear Spring-V8 (75-)
- F 16DA Rear Spring-MGC-Roadster
F 16DB Rear Spring-MGC-GT
- F 16EA Centre Bolt
F 16EB Distance Piece
- F 16FA Clip-2nd Leaf
F 16FB Clip-3rd Leaf
F 16FC Clip-4th Leaf
- F 16GA Clip-2nd Leaf-V8
F 16GB Clip-3rd Leaf-V8
F 16GC Clip-4th Leaf-V8
- F 16HA Rubber Pad-Clip
- F 18AA Front Bush
F 18AB Rear Shackle Bush
- F 18BA Front Bolt
F 18BB Nut
- F 18CA Rear Shackle With Pins
F 18CB Rear Shackle Plate
- F 20AA U-Bolt-Banjo Axle
F 20AB U-Bolt-Tube Axle
F 20AC Nut-Lock
- F 20BA Plate-Spring Locating-Banjo
F 20BB Plate-Spring Locating-Tube
- F 20CA Spring Seating Pad
- F 20DA Bump Pedestal
- F 20EA Rebound Strap (-75)
F 20EB Rebound Strap (75-) & V8
- F 20FA Distance Tube-Rebound Strap

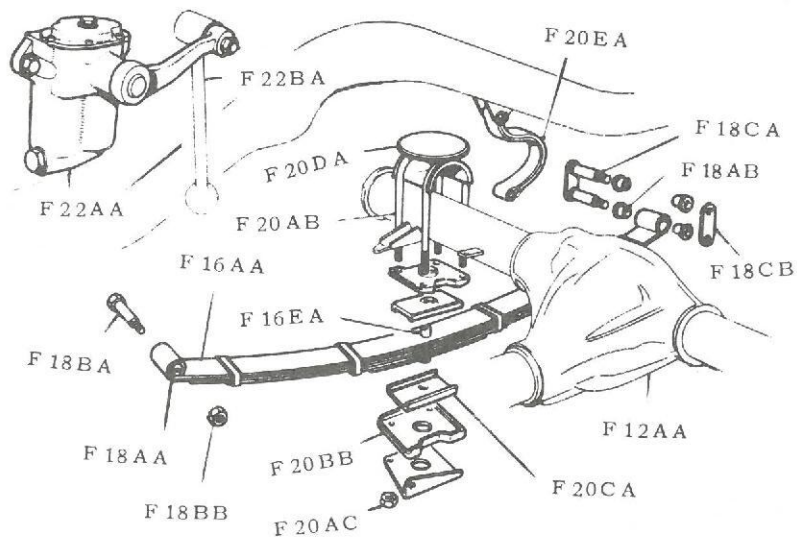

SHOCK ABSORBERS ETC.

F22AA Rear Shock Absorber-RH

F22AB Rear Shock Absorber-LH

F22BA Link (-75 & MGC)

F22BB Link (75- & V8 75-)

F22CA Link-V8 (-75)

F22DA Telescopic Conversion Kit

F22DB Telescopic Shock Absorber

F24AA Mounting Bearing-Rear Anti-Roll Bar (76-)

F24AB End Bush Assy.-Rear Anti-Roll Bar (76-)

HYDRAULICS

CLUTCH

G8AA Master Cylinder (Early)

G8AB Master Cylinder (Late)

G8BA Repair Kit-M/Cyl. (Early)

G8BB Repair Kit-M/Cyl. (Late)

G8CA Master Cylinder-V8

G8CB Repair Kit-M/Cyl.-V8

G8DA Master Cylinder-MGC

G8DB Repair Kit-M/Cyl.-MGC

G10AA Hose-Flexy

G10AB Slave Cylinder

G10AC Repair Kit-Slave Cylinder

G10BA Slave Cylinder-V8

G10BB Repair Kit-Slave Cylinder-V8

G10CA Hose-Flexy-MGC

G10CB Slave Cylinder-MGC

G10CC Repair Kit-Slave Cylinder-MGC

G10DA Slave Cylinder Push Rod

G10DB Slave Cylinder Rod Pin

CLUTCH & BRAKE-M/CYL. RODS & PEDALS

G18AA Pedal Rubber

G18AB Pedal Spring

G18BA Master Cylinder Push Rod

G18BB Master Cylinder Rod Pin

BRAKE: MASTER CYLINDER & SWITCH

G24AA Master Cylinder (-77)

G24AB Repair Kit-M/Cyl.

G24AC Repair Kit-M/Cyl.

G24BA Master Cylinder (77-)

G24BB Repair Kit-M/Cyl. (77-)

G24CA Master Cylinder-MGC
G24CB Repair Kit-MGC

G24DA Stop Lamp Switch (-75)
G24DB Stop Lamp Switch (75-)
G24DC Brake Warning Switch (77-)

G24EA Stop Lamp Switch-MGC

BRAKE: HOSES & PIPES (COPPER ALLOY)

G32AA Front Hose (-76)
G32AB Front Hose (76-)
G32AC Rear Hose

G32BA Front Hose-MGC
G32BB Rear Hose-MGC

G32CA Brake Pipe-M/Cyl. (-72)
G32CB Brake Pipe-M/Cyl. To Servo (75-77)
G32CC Brake Pipe-M/Cyl. To Servo (72-75)
 -Servo To Junction (72-77)

G32DA Brake Pipe-Front-RH (-77)
G32DB Brake Pipe-Front-LH (-77)
G32DC Brake Pipe-Front To Back
G32DD Brake Pipe-Rear-RH
G32DE Brake Pipe-Rear-LH
G32DF Brake Pipe - Front - RH (77-)
G32DG Brake Pipe - Front - LH (77-)

G32EA Brake Pipes - MGC see G32C & D
G32EB Brake Pipe - Calliper - MGC

G32FA Brake Pipe - Copper Alloy
G32FB Brake Pipe Clips

G32GA Male Pipe Nut
G32GB Female Pipe Nut
G32GC Bleed Screw (3/8" UNF)
G32GD Bleed Screw (1/4" UNF)

FRONT BRAKES

G34AA Disc
G34BA Disc - V8
G34CA Disc - MGC

G34DA Calliper Unit—RH
G34DB Calliper Unit—LH
G34DC Repair Kit—Calliper
G34DD Tab Washer

G34EA Calliper Unit—RH—V8
G34EB Calliper Unit—LH—V8
G34EC Repair Kit—Calliper

G34FA Calliper Unit—RH—MGC
G34FB Calliper Unit—LH—MGC
G34FC Repair Kit—Calliper—MGC

G34GA Brake Pads—Genuine
G34GB Brake Pads—Replacement

G34HA Brake Pads—V8

G34JA Brake Pads—Genuine—MGC
G34JB Brake Pads—Replacement—MGC

REAR BRAKES

G42AA Brake Shoes —Genuine
G42AB Brake Shoes— Replacement

G42BA Brake Shoes—Genuine —MGC
G42BB Brake Shoes—Replacement —MGC

G42CA Wheel Cylinder (All But Late GT)
G42CB Wheel Cylinder (Late GT)

G42DA Repair Kit—Wheel Cyl.(All But Late GT)
G42DB Repair Kit—Wheel Cyl. (Late GT)

G42EA Wheel Cylinder—MGC
G42EB Repair Kit—Wheel Cyl.—MGC

G42FA Adjuster
G42FB Retaining Clip—Wheel Cyl.
G42FC Drum Screw

G42GA Adjuster—RH—MGC
G42GB Adjuster—LH—MGC

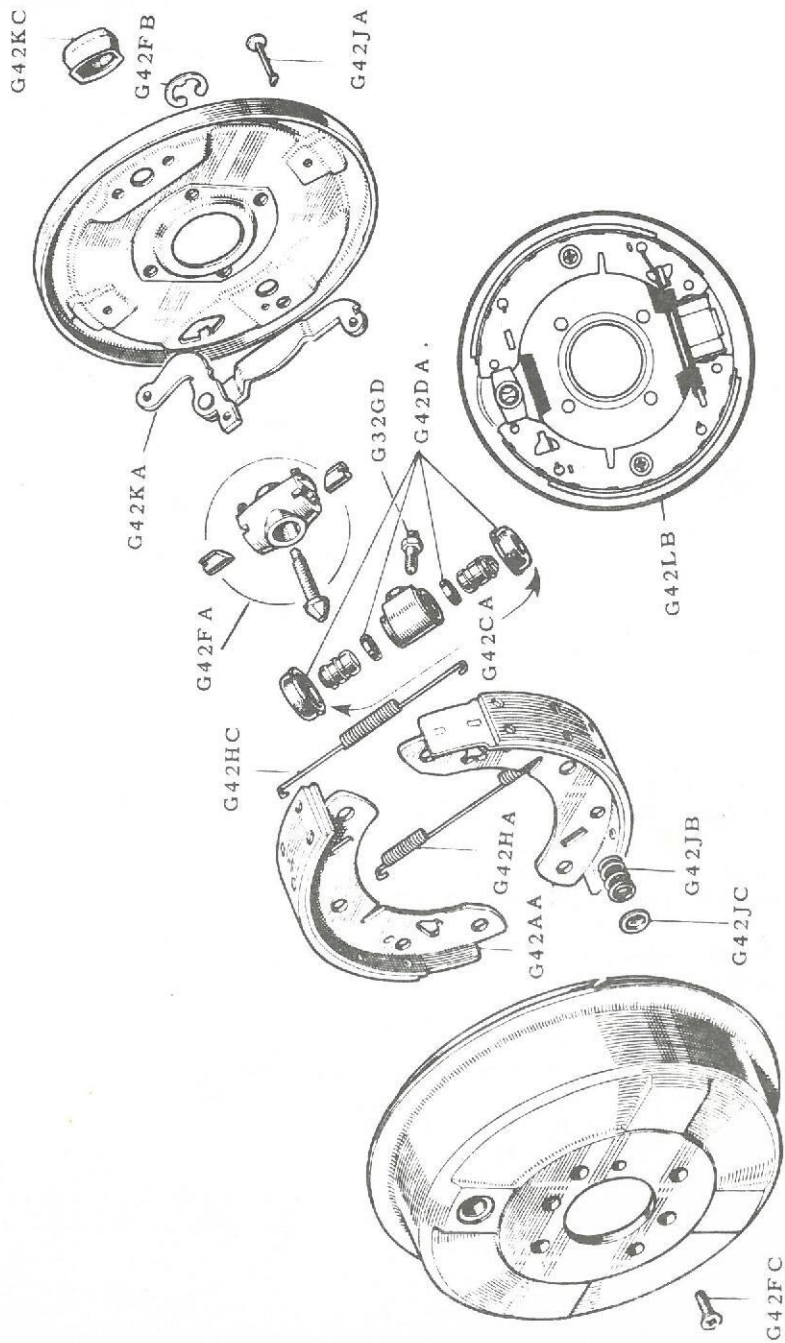

G42HA Brake Spring-Cylinder End-RH
G42HB Brake Spring-Cylinder End-LH
G42HC Brake Spring-Adjuster End
G42HD Handbrake Spring-Banjo Axle
G42HE Handbrake Spring-Tubed Axle

G42JA Pin-Shoe Steady
G42JB Spring
G42JC Washer-Spring Retaining

G42KA Lever-Handbrake-RH
G42KB Lever-Handbrake-LH
G42KC Dust Seal-Lever

G42LA Backplate Complete-RH
G42LB Backplate Complete-LH

HANDBRAKE

G44AA Handbrake Cable-Steel Wheels
G44AB Handbrake Cable-Wire Wheels

G44BA Handbrake Cable-Steel Wheels-MGC
G44BB Handbrake Cable-Wire Wheels-MGC

G44CA Handbrake Cable Spring
G44CB Handbrake Clevis Pin
G44CC Handbrake Cable Adjuster Nut

SERVO

G46AA Servo (-77)
G46AB Servo (77-)

G46BA Servo Repair Kit (-77)
G46BB Air Control Valve Kit (-77)
G46BC Non Return Valve

G46CA Servo Repair Kit (77-)

G46DA Hose-Vacuum
G46DB Hose-Air Control

G46EA Servo - MGC
G46EB Servo Repair Kit-MGC

ELECTRICAL, INSTRUMENTS, ETC.

IGNITION (DISTRIBUTOR, CAP, POINTS, ROTOR, PLUGS & CONDENSER)

H2AA Distributor (-75)

H2AB Distributor (75-)

H2BA Distributor - V8

H2CA Electronic Ignition Kit-Lumenition(-75)

H2CB Electronic Ignition Kit-Lumenition(75-)

H2DA Electronic Ignition Kit-Lumenition-V8

H2EA Distributor Cap(-68)

H2EB Distributor Cap(68-75)

H2EC Distributor Cap(75-)

H2FA Distributor Cap-V8

H2GA Distributor Cap-MGC

H4AA Rotor Arm (-75)

H4AB Contact Breaker(-75)

H4BA Rotor Arm (75-)

H4BB Contact Breaker (-75)

H4CA Rotor Arm-V8

H4CB Contact Breaker -V8

H4DA Rotor Arm-MGC

H4DB Contact Breaker - MGC

H4EA Condenser(-75)

H4EB Condenser(75-)

H4FA Spark Plug-MGB & C

H4GA Spark Plug - V8

IGNITION(DISTRIBUTOR PARTS,COIL & HT LEAD

H6 AA Distributor LT Terminal & Lead(-75)

H10AA Vacuum Pipe (-68)

H10AB Connection-Carb. End(-68)

H10BA Vacuum Pipe Kit(68-)

H10BB Connection-Straight(68-)

H10BC Connection-Bent(68-)

H12AA Ignition Coil (-74) & MGC

H12AB Ignition Coil (74-) & V8

H12BA Nut-Coil HT Terminal

H12BB Split Washer

H12BC Clip-HT Lead End

H12CA HT Lead Set (-68)

H12CB HT Lead Set (68-)

H12DA Spark Plug Cap

H12DB HT Lead

BATTERY

H18AA Battery 6v

H18AB Battery 12v

H18BA Clamp- 6v-One Sided

H18BB Clamp- 6v-All Round

H18BC Clamp - 12v

H18CA Packing - Under Clamp

H18DA Bolt -6v - J

H18DB Bolt - 12v - J

H18EA Battery Clamp Kit

DYNAMO, ALTERNATORS, STARTERS, FUSES

H20AA Dynamo (-68)

H22AA Alternator (-75)
H22AB Alternator (75-76)
H22AC Alternator (76-)

H22BA Alternator - V8

H24AA Dynamo Brushes
H24AB Alternator Brushes (68-69)
H24AC Alternator Brushes (69-)

H24BA Starter Brushes (-68)
H24BB Starter Brushes (68-)

H32AA Starter (-68)

H34AA Starter (68-71)
H34AB Starter (71-)

H34BA Starter - V8

H34CA Starter - MGC

H38AA Dynamo Control Box (-68)
H38AB Alternator Control Box (68-70)

H38BA Overdrive Vacuum Hose (-68)
H38BB Starter Solenoid (-68)
H38BC Starter Solenoid (68-71)
H38BD Starter Solenoid (71-)

H38CA Fuse Box (-70)
H38CB Fuse Box (71-)
H38CC Fuse Box - Universal

H38DA Fuse

H38EA Plastic Fuse Box Nut

BATTERY CABLES

H48AA Earth Strap-Battery

H48AB Earth Strap-Engine

H48BA Battery Terminal Clamp-Positive

H48BB Battery Terminal Clamp-Negative

SWITCHES DASHBOARD, CONSOLE &

DOOR OPERATED

H56AA Switch - Lights (-66)

H56AB Switch - Lights (67-72)

H56AC Switch - Lights (73-76)

H56AD Switch - Lights (76-)

H56BA Switch - Wipers (-68)

H56BB Switch - Wipers (68-72)

H56BC Switch - Wipers (72-75)

H56CA Switch - Heater (-72)

H56CB Switch - Heater (73-76)

H56CC Switch - Heater (76--)

H56DA Rheostat - Panel Lamp - (76-)

H56DB Rheostat - Panel Lamp (76--)

H56EA Overdrive Switch (-75)

H58AA H.R.W. Switch (72-76)

H58AB H.R.W. Switch (76-)

H58BA Auxiliary Lamp Switch (72-)

H58CA Hazard Switch (72-75)

H58CB Hazard Switch (75-76)

H58CC Hazard Switch (76-)

H60AA Interior Light Switch-Door Operated

H60AB Interior Light Switch-Tailgate Operated

H60AC Boot Interior Light Switch-Roadster

COLUMN SWITCHES & FLASHER UNITS

- H62AA Switch-Indicator/Flash (-72)
- H62AB Switch-Indicator/Flash/Dip/Horn(70-71)
- H62AC Switch-Indicator/Flash/Dip(71-75)

- H62BA Switch-Indicator/Flash/Dip(75-76) & V8
- H62BB Switch-W/Wiper & O/Drive (75-76) & V8

- H62CA Switch-Indicator/Flash/Dip (76-)
- H62CB Switch-W/Wiper & Washer (76-)

- H64AA Flasher (-68)
- H64AB Flasher (68-)
- H64AC Flasher - Hazard

FRONT LAMPS

- H78AA Headlamp Bucket - Lucas
- H78AB Headlamp Bucket - Replacement
- H78AC Headlamp Adjuster Kit

- H78BA Mounting Rim - Sealed Beam Unit Back
- H78BB Mounting Rim - Sealed Beam Unit-Chrome

- H78CA Headlamp Chrome Rim
- H78CB Rim Clip

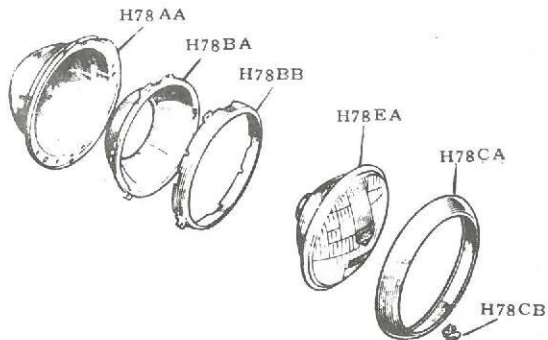

- H78DA Gasket - Headlamp
- H78DE Fixing Rim - Headlamp

- H78EA Headlamp Unit (-76)
- H78EB Headlamp Unit (76-)

- H78FA Halogen Headlamp Kit - Pair (-75)
- H78FB Halogen Headlamp Kit - Pair (75-)

- H86AA Front Side/Flasher Unit
- H86AB Front Side/Flasher Body with Wiring
- H86AC Front Side/Flasher Body without Wiring

- H86BA Front Side Lens
- H86BB Front Flasher Lens

- H86CA Interior Kit - Flasher
- H86CB Interior Kit - Sidelamp

- H86DA Side/Flasher Gasket
- H86DB Grommet - Sidelamp
- H86DC Grommet - Flasher

- H86EA Front Side/Flasher Rim
- H86EB Front Side/Flasher Screw

- H86FA Front Flasher Lamp (75-)
- H86FB Front Flasher Lens (75-)

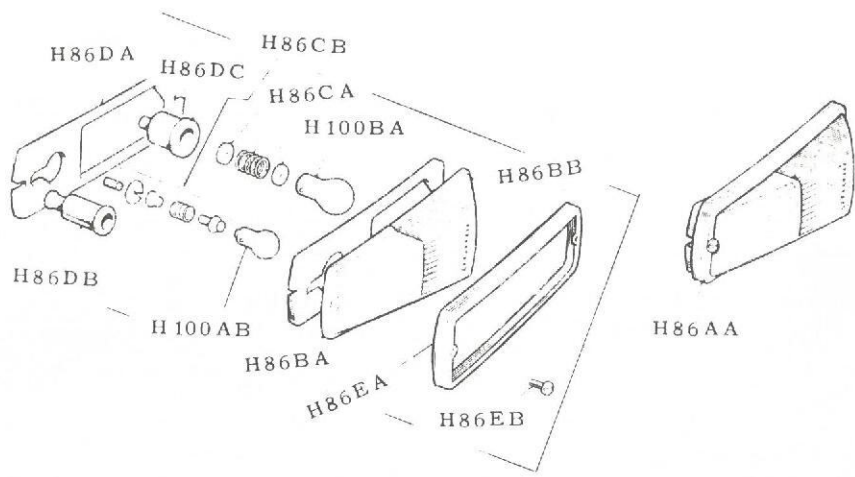

REAR LAMPS

- H90AA Rear Lamp Assy. (-70)
- H90AB Rear Lamp Rim (-70)

- H90BA Rear Lens-Amber (-70)
- H90BB Rear Lens-Red (-70)

- H90CA Rear Lamp Assy. (70-)
- H90CB Rear Lamp Lens (70-)

- H94AA No. Plate Lamp (-74)
- H94AB No. Plate Lamp Cover (-74)
- H94AC Screw (-74)

- H94BA No. Plate Lamp Plinth RH (-74)
- H94BB No. Plate Lamp Plinth LH (-74)

- H94CA No. Plate Lamp (75-)
- H94CB No. Plate Lamp Cover (75-)

- H96AA Reversing Lamp
- H96AB Reversing Lamp Lens

INTERIOR LAMP

- H98AA Interior Lamp Dash (72-)
- H98AB Interior Lamp-Boot Roadster (72-)
- H98AB Interior Lamp-Roof GT

LIGHT BULBS

- H100AA Halogen (76-)
- H100AB Side (-75)
- H100AC Side (75-76)
- H100AD Side (76-)

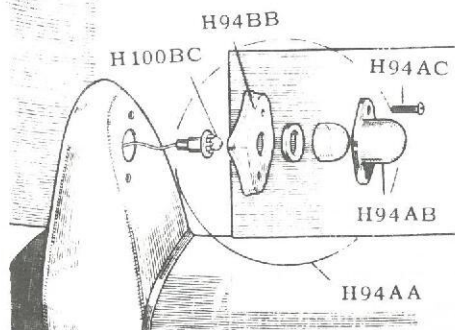

- H100BA Flasher
- H100BB Stop/Tail
- H100BC No. Plate (-75)
- H100BD Reverse
- H100BE No. Plate (76-)

- H100CA Interior (Courtesy)
- H100CB Instrument (Screw Type)
- H100CC Instrument (Bayonet Type) Type L
- H100CD Switch (76-)

WINDSCREEN WIPERS

H 104AA Arm-Roadster (62-69) - Genuine
H 104AB Blade-Roadster (62-69)
H 104AC Arm-Roadster (62-69) -Replacement
H 104AD Blade-Roadster (62-69) - Replacement

H104BA Arm-Roadster (62-72) - Genuine
H 104BB Blade-Roadster (69-72) - Genuine

H 104CA Arm-Roadster (72-) Genuine
H 104CB Blade-Roadster (72-) Genuine
H 104CC Arm-Roadster (72-) Replacement
H 104CD Blade-Roadster (72-) Replacement

H 106AA Arm-GT (65-69) Genuine
H 106AB Blade-GT (65-69) Genuine
H 106AC Arm-GT(65-69) Replacement
H 106AD Blade-GT (65-69) Replacement

H 106BA Arm-GT (69-72) Genuine
H 106BB Blade-GT (69-72) Genuine

H 106CA Arm-GT(72-) Genuine
H 106CB Blade-GT (72-) Genuine
H 106CC Arm-GT (72-) Replacement
H 106CD Blade-GT (72-) Replacement

H 108AA Windscreen Wiper Motor-1-Speed
H 108AB Windscreen Wiper Motor-2-Speed

H 108BA Wheelbox-Roadster
H 108BB Wheelbox-GT

H 108CA Wheelbox Bush Kit -Roadster
H 108CB Wheelbox Bush Kit-GT

SPEEDOMETER & CABLES

H 116AA Speedo-Non O/D (-68)
H 116AB Speedo-O/D (-68)

H 116BA Speedo-Non O/D (68-75)
H 116BB Speedo-O/D (68-75)
H 116BC Speedo-Auto (68-75)

H116CA Speedo (75-76)
H116CB Speedo (76-)

H116DA Speedo-V8

H116EA Speedo-Non O/D-MGC
H116EB Speedo O/D-MGC

H118AA Trip Cable (75-)

H118BA Speedo Cable-Non O/D (-68)
H118BB Speedo Cable-Non O/D (68-)
H118BC Speedo Cable-O/D (68-76)
H118BD Speedo Cable (76-)

H118CA Speedo Cable-MGC-Non O/D
H118CB Speedo Cable-MGC-O/D

TACHOMETER, OTHER GAUGES
VOLTAGE STABILIZER

H124AA Rev-Counter (68-72)
H124AB Rev-Counter (73-75)

H124BA Rev-Counter (75-76)
H124BB Rev-Counter (76-)

H124CA Rev-Counter-V8

H124DA Rev-Counter-MGC

H132AA Oil/Temp Gauge-Fahr.
H132AB Oil/Temp Gauge-C-N-H

H132BA Voltage Stabilizer-Positive Earth
H132BB Voltage Stabilizer-Negative Earth

H134AA Oil/Temp Gauge-V8

H136AA Other Gauges

WELDED PANELS

REAR PANEL & REAR WING

I10AA Rear Panel (-75)

I10BA Rear Panel (75-)

I10CA Boot Floor Support-RH-GT Only

I10CB Boot Floor Support-LH-GT Only

I12AA Rear Wing-Roadster-RH (-75)

I12AB Rear Wing-Roadster-LH (-75)

I12BA Rear Wing-Roadster-RH (75-)

I12BB Rear Wing-Roadster-LH (75-)

I12CA Rear Wing-GT-RH (-75)

I12CB Rear Wing-GT-LH (-75)

I12DA Rear Wing-GT-RH (75-)

I12DB Rear Wing-GT-LH (75-)

I12EA Rear Wing-RH-Fibreglass

I12EB Rear Wing-LH-Fibreglass

I12FA Rear Wing-Small Repair Panel-RH

I12FB Rear Wing-Small Repair Panel-LH

I12GA Rear Wing-Large Repair Panel-RH

I12GB Rear Wing-Large Repair Panel-LH

I12HA R/Wing Repair-Door To Rear Lamp-RH

I12HB R/Wing Repair-Door To Rear Lamp-LH

I12JA Rear Arch To Lamp Repair Panel-RH

I12JB Rear Arch To Lamp Repair Panel-LH

SILLS

I14AA Full Sill-RH

I14AB Full Sill-LH

I14BA Skin Sill

I14BB Sill With Step

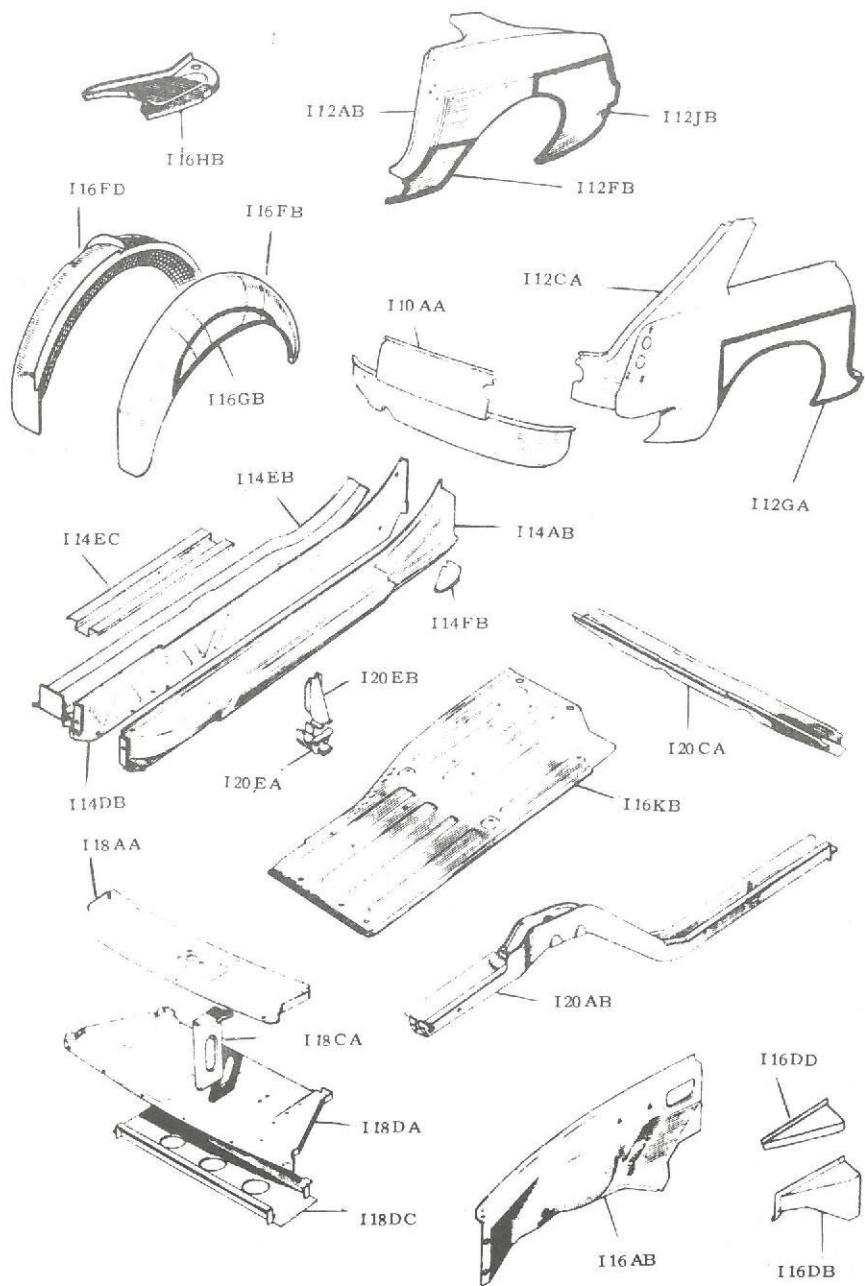

I14CA Skin Sill With Extn. To Rear Arch-RH
I14CB Skin Sill With Extn. To Rear Arch-LH

I14DA Inner Sill-RH
I14DB Inner Sill-LH

I14EA Joining Panel-Floor To Sill-RH
I14EB Joining Panel-Floor To Sill-LH
I14EC Repair Sections For Above

I14FA Sill Rear End Filler-RH
I14FB Sill Rear End Filler-LH

I14GA Sill End Side Filler-RH
I14GB Sill End Side Filler-LH

INNER WHEEL ARCHES & FLOORS

I16AA Front Inner Wing-RH (-75)
I16AB Front Inner Wing-LH (-75)

I16BA Front Inner Wing-RH (75-76)
I16BB Front Inner Wing-LH (75-76)

I16CA Front Inner Wing-RH (76-)
I16CB Front Inner Wing-LH (76-)

I16DA Front Wheel Arch Reinforcement-RH
I16DB Front Wheel Arch Reinforcement-LH
I16DC Reinf. Top Repair-RH
I16DD Reinf. Top Repair-LH

I16EA Front Wheel Arch Reinforcement-MGC-RH
I16EB Front Wheel Arch Reinforcement-MGC-LH

I16FA Inner Rear Arch-Outer Half-RH
I16FB Inner Rear Arch-Outer Half-LH
I16FC Inner Rear Arch-Inner Half-RH
I16FD Inner Rear Arch-Inner Half-LH

I16GA Inner Rear Arch-Outer Repair-RH
I16GB Inner Rear Arch-Outer Repair-LH

I16HA Boot Floor Outer-RH
I16HB Boot Floor Outer-LH

I16JA Floor Panel (-68) RH

I16JB Floor Panel (-68) LH

I16KA Floor Panel (68-) RH

I16KB Floor Panel (68-) LH

RADIATOR DUCTING

I18AA Bonnet Closing Panel (-75)

I18AB Bonnet Closing Panel (75-) & V8

I18BA Bonnet Closing Panel-MGC

I18CA Support-Bonnet Closing (-75)

I18CB Support-Bonnet Closing (75-) & V8

I18DA Radiator Duct Panel (-75)

I18DB Radiator Duct Panel (75-)

I18DC Support-Rad.Duct Panel (-75)

I18DD Support-Rad. Duct Panel (75-)

I18EA Inner Wing-Front Repair Panel-RH

I18EB Inner Wing-Front Repair Panel-LH

CHASSIS

I20AA Chassis Leg Front (-75) RH

I20AB Chassis Leg Front (-75) LH

I20BA Chassis Leg Front (75-) RH

I20BB Chassis Leg Front (75-) LH

I20CA Centre Cross Member

I20DA Jacking Member-RH

I20DB Jacking Member-LH

I20DC Jacking Member-Short

I20EA Jacking Point

I20EB Reinforcer-Jacking Point

I20FA Rear Chassis Leg Repair Section-RH (-75)

I20FB Rear Chassis Leg Repair Section-LH (-75)

BOLTED PANELS

FRONT VALANCE & SPOILERS

I22AA Front Valance (-75)

I22AB Front Valance (75-)

I22BA Front Spoiler-Bolts To Front Valance

I22BB Front Spoiler-Replaces Front Valance

I22CA Rear Spoiler-Roadster

I22CB Rear Spoiler-GT

FINISHERS: WING DOOR ROOF

I24AA Front Wing Moulding-RH

I24AB Front Wing Moulding-LH

I24BA Door Moulding-RH

I24BB Door Moulding-LH

I24CA Rear Wing Moulding-RH

I24CB Rear Wing Moulding-LH

I24DA Moulding Rivet Clip

I24DB Moulding Screw Clip

I24DC Nut

I24EA BL Motif-F/Wing

I24EB Fixings-Blind

I24FA V8 Motif-Silver

I24FB V8 Motif-Gold

I24GA Finisher-Roof-Front-RH

I24GB Finisher-Roof-Front-LH

I24GC Finisher-Roof-Rear-RH

I24GD Finisher-Roof-Rear-LH

I24GE Clip

I24HA Badge-Rear Quarter-RH (75-)

I24HB Badge-Rear Quarter-LH (75-)

I24JA Finisher-Door Weatherstrip-GT-RH

I24JB Finisher-Door Weatherstrip-GT-LH

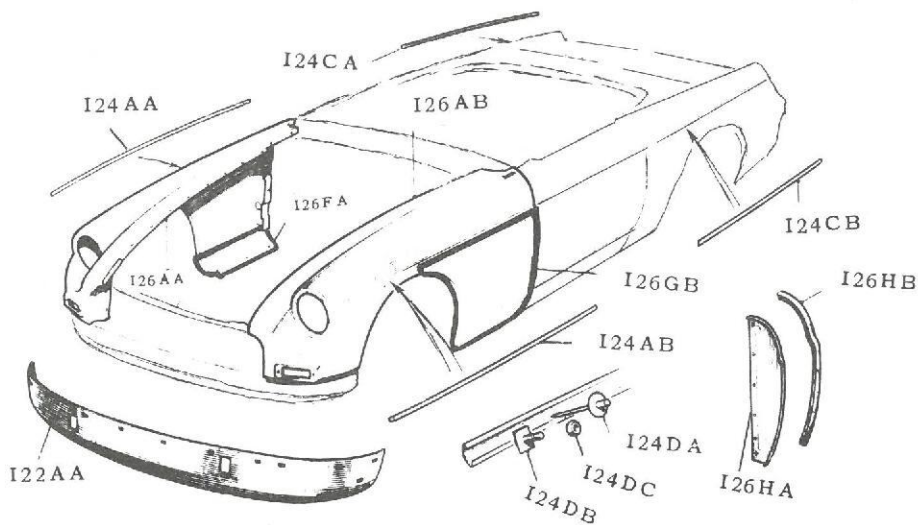

FRONT WING

- I26AA Front Wing-Roadster-RH (-70)
 I26AB Front Wing-Roadster-LH (-70)
 I26AC Front Wing-Roadster-RH (70-75)
 I26AD Front Wing-Roadster-LH (70-75)
- I26BA Front Wing-GT-RH (-70)
 I26BB Front Wing-GT-LH (-70)
 I26BC Front Wing-GT-RH (70-75)
 I26BD Front Wing-GT-LH (70-75)
- I26CA Front Wing-Roadster-RH (75-)
 I26CB Front Wing-Roadster-LH (75-)
 I26CC Front Wing-GT-RH (75-)
 I26CD Front Wing-GT-LH (75-)
- I26DA Front Wing-Roadster-Fibreglass-RH
 I26DB Front Wing-Roadster-Fibreglass-LH
- I26EA Front Wing-GT-Fibreglass-RH
 I26EB Front Wing-GT-Fibreglass-LH

I26FA Front Wing Repair Panel-Small-RH
I26FB Front Wing Repair Panel-Small-LH

I26GA Front Wing Repair Panel-Large-RH
I26GB Front Wing Repair Panel-Large-LH

I26HA Splash Panel
I26HB Seal-Splash Panel

I26JA Splash Panel-Small Upper

DOOR

J2AA Door-Roadster-RH (65-68)
J2AB Door-Roadster-LH (65-68)

J2BA Door-Roadster-RH (68-)
J2BB Door-Roadster-LH (68-)

J2CA Door-GT-RH (68-)
J2CB Door-GT-LH (68-)

J2DA Door-Reskinned-RH (-65)
J2DB Door-Reskinned-LH (-65)

J2EA Door-Reskinned-RH (66-68)
J2EB Door-Reskinned-LH (66-68)

J2FA Door-Reskinned-RH (68-)
J2FB Door-Reskinned-LH (68-)

J2GA Door Skin-RH
J2GB Door Skin-LH

J2HA Door Half Skin-RH
J2HB Door Half Skin-LH

J2JA Door Bottom-RH
J2JB Door Bottom-LH

J2KA Door Hinge Screws

J4AA ~~RR-glass~~ Sill Tread Plate

J4BA Door Weatherstrip-RH
J4BB Door Weatherstrip-LH
J4BC Clip-Weatherstrip To Finisher-GT

DOOR HANDLES & LOCKS

J10AA Door Handle (-65)RH
J10AB Door Handle (-65) LH

J10BA Door Handle (65-68)
J10BB Door Handle (68-)

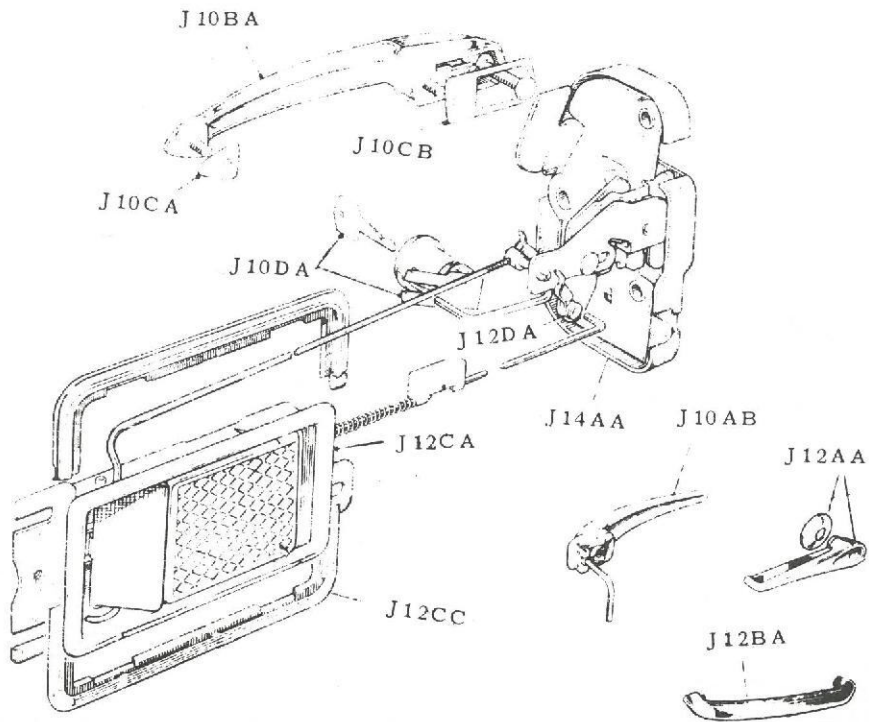

J10CA Door Handle Gasket-Front
J10CB Door Handle Gasket-Rear

J10DA Door Lock (Barrel) RH
J10DB Door Lock (Barrel) LH
J10DC Fibre Washer

J12AA Interior Remote Lock Handle (-68)

J12BA Interior Door Pull (-68)
J12BB Interior Door Pull (68-72)

J12CA Interior Remote(RH)Lock Handle (68-)
J12CB Interior Remote(LH)Lock Handle (68-)
J12CC Bezel

J12DA Lock Rod Clips

J14AA Door Lock-RH (65-68)
J14AB Door Lock-LH (65-68)

J14BA Door Lock-RH (68-)
J14BB Door Lock-LH (68-)

DROP GLASS,ETC

J16AA Door Glass-Roadster-RH
J16AB Door Glass-Roadster-LH

J16BA Door Glass-GT-RH
J16BB Door Glass-GT-LH

J16CA Door Glass Tinted-GT-RH
J16CB Door Glass Tinted-GT-LH

J16DA Glazing Rubber Strip

J16EA Channel Assy.-RH
J16EB Channel Assy.-LH

J16FA Rear Channel Flexy Insert

J18AA Window Regulator-RH
J18AB Window Regulator-LH

J18BA Winder Handle (-68)

J18CA Winder Handle (68-)

J18CB Screw

QUARTER LIGHTS

J20AA Quarter Light Assy.-Roadster-RH

J20AB Quarter Light Assy.-Roadster-LH

J20AC Quarter Light Assy.-GT-RH

J20AD Quarter Light Assy.-GT-LH

J20BA Glass-Quarter Light-Tinted-GT-RH

J20BB Glass-Quarter Light-Tinted-GT-LH

J20CA Handle-Quarter Light-(-68) RH

J20CB Handle-Quarter Light-(-68) LH

J20DA Handle-Quarter Light-(68-) RH

J20DB Handle-Quarter Light-(68-) LH

J20EA Handle Bracket

J20EB Pin--Retaining

J20FA Top Pivot Bracket-Roadster-RH

J20FB Top Pivot Bracket-Roadster-LH

J20FC Top Pivot-Roadster-RH

J20FD Top Pivot-Roadster-LH

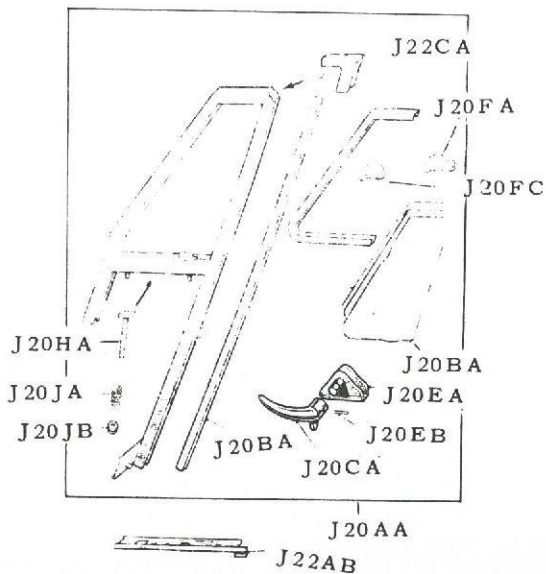

J20GA Top Pivot Bracket-GT-RH
J20GB Top Pivot Bracket-GT-LH
J20GC Top Pivot-GT-RH
J20GD Top Pivot-GT-LH

J20HA Lower Pivot Pin-Roadster (-72)
J20HB Lower Pivot Pin-Roadster (72-)
J20HC Lower Pivot Pin-GT (-72)
J20HD Lower Pivot Pin-GT (72-)

J20JA Spring-Pivot Pin
J20JB Nut-Nyloc

J22AA Quarter Light To Door Gasket-RH
J22AB Quarter Light To Door Gasket-LH

J22BA Front Channel Flexy Insert

J22CA Top Corner Rubber Block (-72)
J22CB Top Corner Rubber Block (72-)

BONNET

K2AA Bonnet
K2AB Bonnet Cable

K2BA Bonnet-MGC

K4AA Rear Seal-Flat
K4AB Rear Seal-Edge
K4AC Seal-Radiator Panel

K4BA Front Moulding (70-72)

K4CA Heater Air Grille
K4CB Fixings

K4DA Bonnet Insulating Pad-Front
K4DB Bonnet Insulating Pad-Rear

K4EA Bonnet Seating Rubber Block

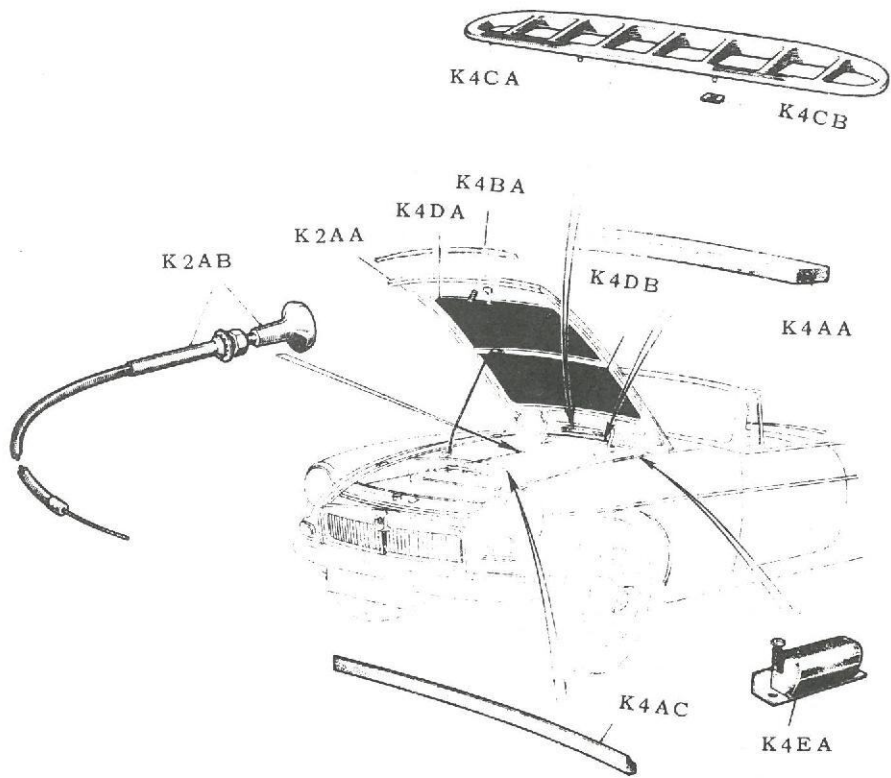

BOOT LID & TAILGATE

K6AA Boot Lid (-76)

K6AB Boot Lid (76-)

K6BA Tailgate

K6CA Spring Steady-Tailgate-RH

K6CB Spring Steady-Tailgate-LH

K6DA Spring Cover

K6DB Large Cap-Cover

K6EA Boot Lid Seal (-76)

K6EB Boot Lid Seal(76-)

K6FA Tailgate Seal-Inner

K6FB Tailgate Seal-Outer

K6GA Boot/Tailgate Lock

K6GB Boot Lock Gasket

BADGES: BOOT LID & TAILGATE

K8AA Octagon Kit-MG (-70)

K8AB MG-B-GT Kit (-70)

K8AC Fixings-Open

K8AD Fixings-Blind

K8BA MGB-Motif - Roadster

K8BB Fixings-Open

K8CA Octagon-One Piece (70-)

K8CB Fixings-Open

K8CC Fixings-Blind

K8DA 'B' Motif (70-72)

K8DB 'GT' Motif (70-72)

K8EA MG-BGT Motif Silver-GT (73-)

K8EB MG-BGT Motif Gold-GT (73-)

K8EC Fixings-Blind

K8FA V8-Motif-Silver

K8FB V8-Motif-Gold

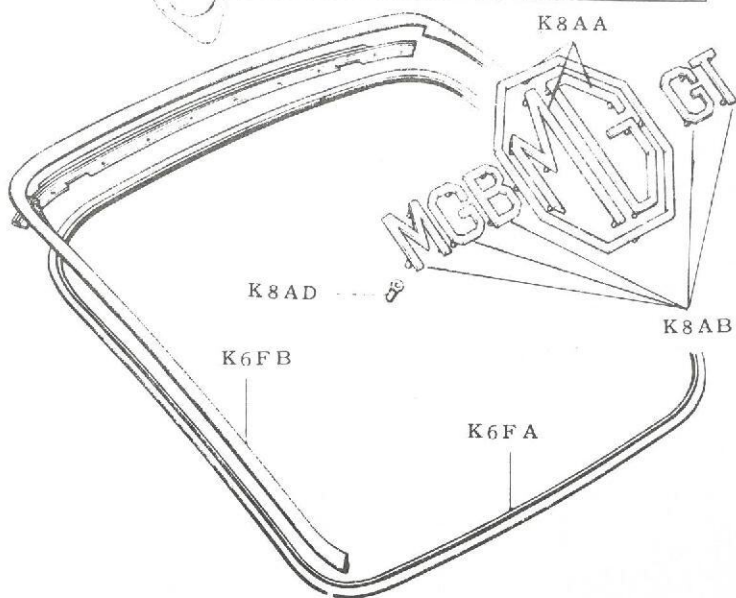
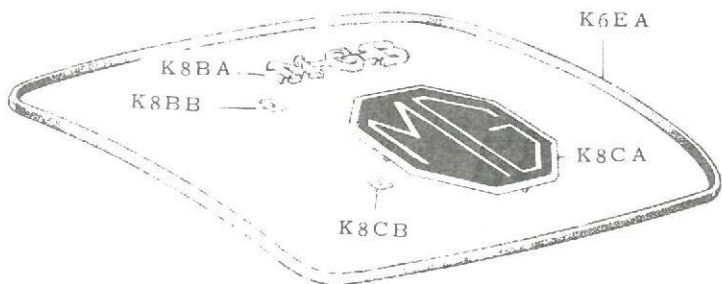

SOFT TOP, TONNEAU, HARDTOP

SOFT TOP & FITTINGS

- K 10AA Hood-Packaway (-72)
- K 10AB Hood-Fold Down (-72)

- K 10BA Hood-Fold Down (72-75)
- K 10BB Hood-Fold Down-Genuine (72-75)

- K 10CA Hood-Zip Rear Window (75-)
- K 10CB Hood-Zip Rear Window Genuine (75-)

- K 12AA Hood Fastener Tongue
- K 12AB Socket-Tongue Locating
- K 12AC Backplate

- K 12BA Hood Fastener Peg-Rear Scuttle
- K 12BB 'Lift The Dot' Fastener
- K 12BC Fastener Washer

- K 12CA Stud-Button Fixing
- K 12CB Button-Fastener
- K 12CC Socket-Fastener

- K 12DA Peg-Dash & Heelboard Fastener

- K 12EA Hood Frame Fixing Screws

- K 14AA Front Fastener Clip
- K 14AB Header Rail
- K 14AC Header Rail-Complete

- K 14BA Seal-Header Rail
- K 14BB Seal Retainer

TONNEAU & HARDTOP

- K 16AA Stowage Cover-Folding Hood

- K 18AA Tonneau-Without Headrest Pockets
- K 18AB Tonneau-With Headrest Pockets

- *
K 20AA Hardtop

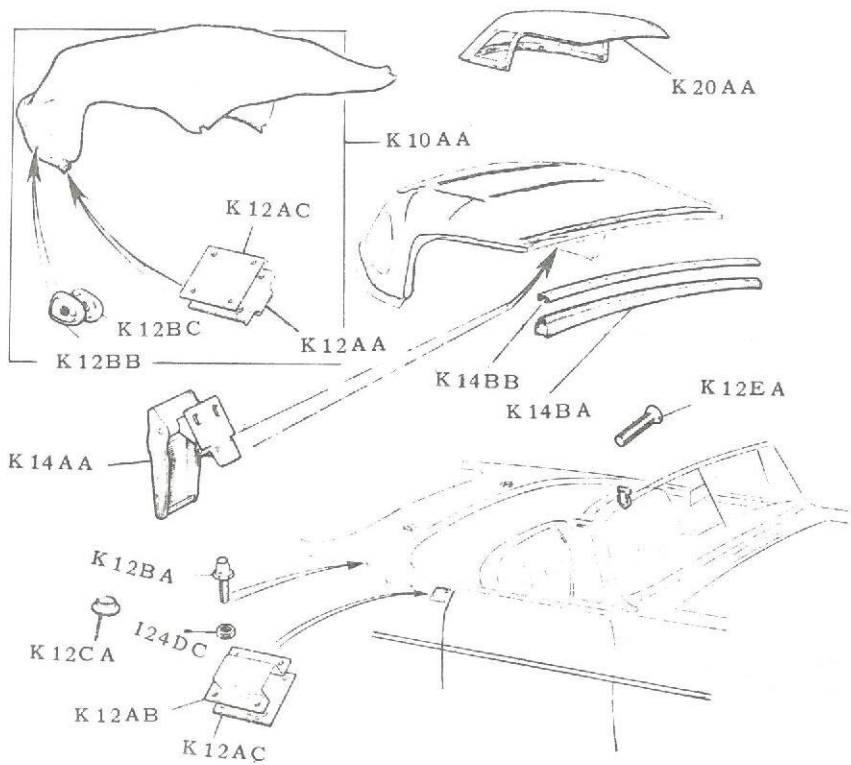

GRILLE, BUMPERS

GRILLE

- L2AA Grille Assy. (-70)
- L2AB Grille Case (-70 & 72-75)
- L2AC Grille Motif Housing (-70 & 72-75)

- L2BA Grille Motif (-70)

- L2CA Bracket-Grille-Centre (-70 & 72-75)
- L2CB Bracket-Grille-RH (-70 & 72-75)
- L2CC Bracket-Grille-LH (-70 & 75-75)

- L2DA Grille Panel (70-72)
- L2DB Lower Surround Panel (70-72)
- L2DC Finisher-Upper (70-72)
- L2DD Finisher-Lower (70-72)

- L2EA Side Panel-RH (70-72)
- L2EB Side Panel-LH (70-72)

- L2FA Clips-Finisher (70-72)

- L2GA Grille Motif (70-72)
- L2GB Motif Housing (70-72)
- L2GC Fastener (70-72)

- L4AA Grille Assy. (72-75)
- L4AB Grille Motif (72-75)
- L4AC V8 Motif

- L4BA Plastic Honeycomb (Pair)
- L4BB Top Fixing Strip
- L4BC Lower Bracket Kit

- L4CA Grille (75-)

FRONT CHROME BUMPER

- L6A A Front Bumper (-75)

- L6BA Front Over-Rider (-71)

- L6CA Front Over-Rider (71-75)

- L6DA Over-Rider Moulding Strips

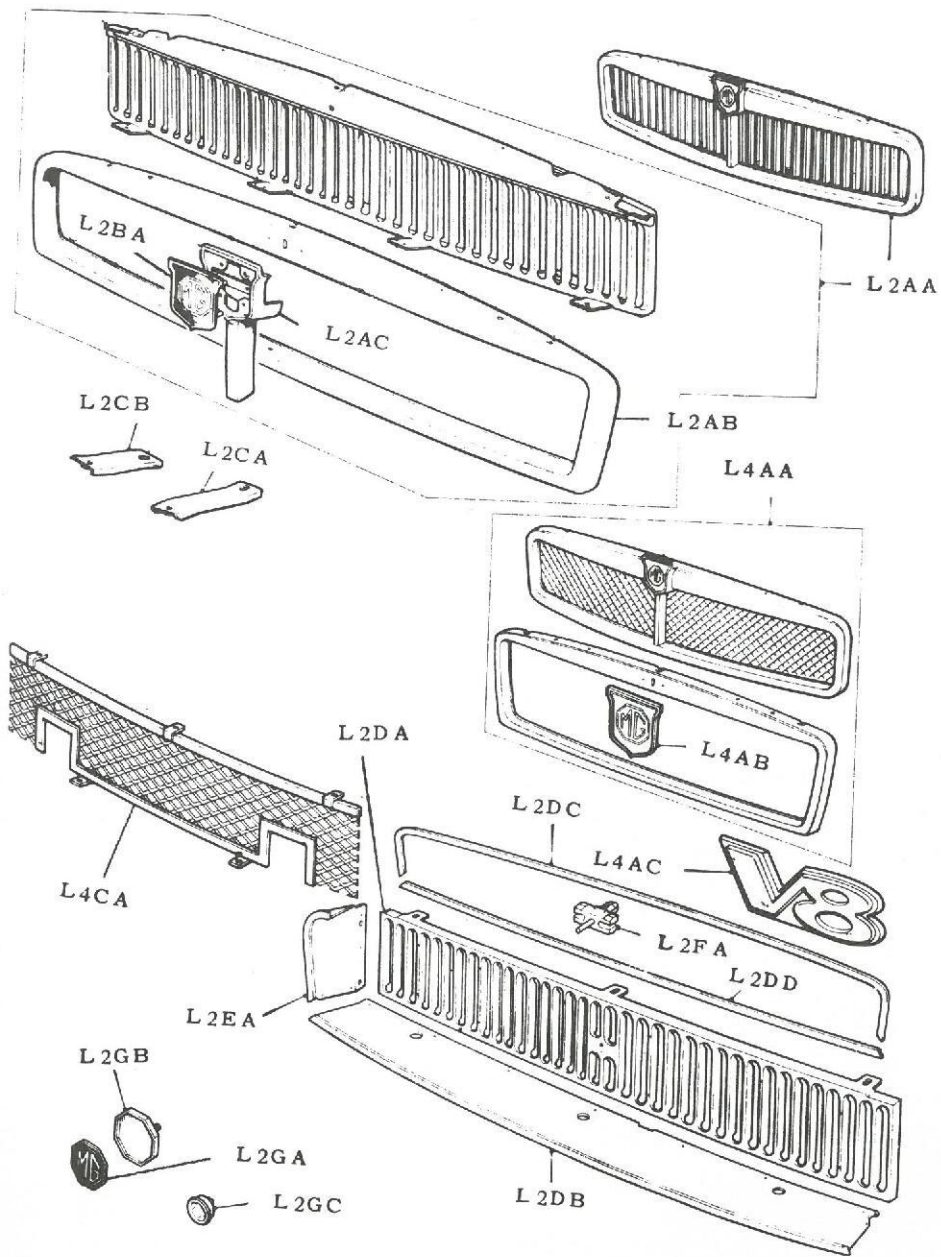

L6DA Over-Rider Moulding Strips
L6DB Buffer (71-75)

L6EC Bumper Bolts-Chrome
L6ED Over-Rider Bolts (71-75)

L6FA Side Steady Bracket
L6FB Pad-Steady Bracket

L6GA Bolt-Front Bumper Iron to Chassis-Rear
L6GB Bolt-Front Bumper Iron to Chassis-Front

REAR CHROME BUMPER - 75

L8AA Rear Bumper

L8BA Rear Over-Rider-RH (-71)
L8BB Rear Over-Rider-LH (-71)

L8CA Rear Over-Rider-RH (71-75)
L8CB Rear Over-Rider-LH (71-75)

L8DA R/Bumper Mounting Bracket
L8DB Nut
L8DC Bolt

L8EA Rear Bumper Corner Filler-RH
L8EB Rear Bumper Corner Filler-LH

RUBBER BUMPER 75-

L10AA Front Bumper
L10AB Rear Bumper

L10BA Iron-Fr. Bumper - RH
L10BB Iron-Fr. Bumper - LH

L10CA Fixing Rivets

L10DA Side Fixing-Rear
L10DB Distance Piece

L10EA Badge-Front-Silver
L10EB Badge-Front-Gold

NUMBER PLATE

L12AA No. Plate Plate
L12AB Front No. Plate Bracket

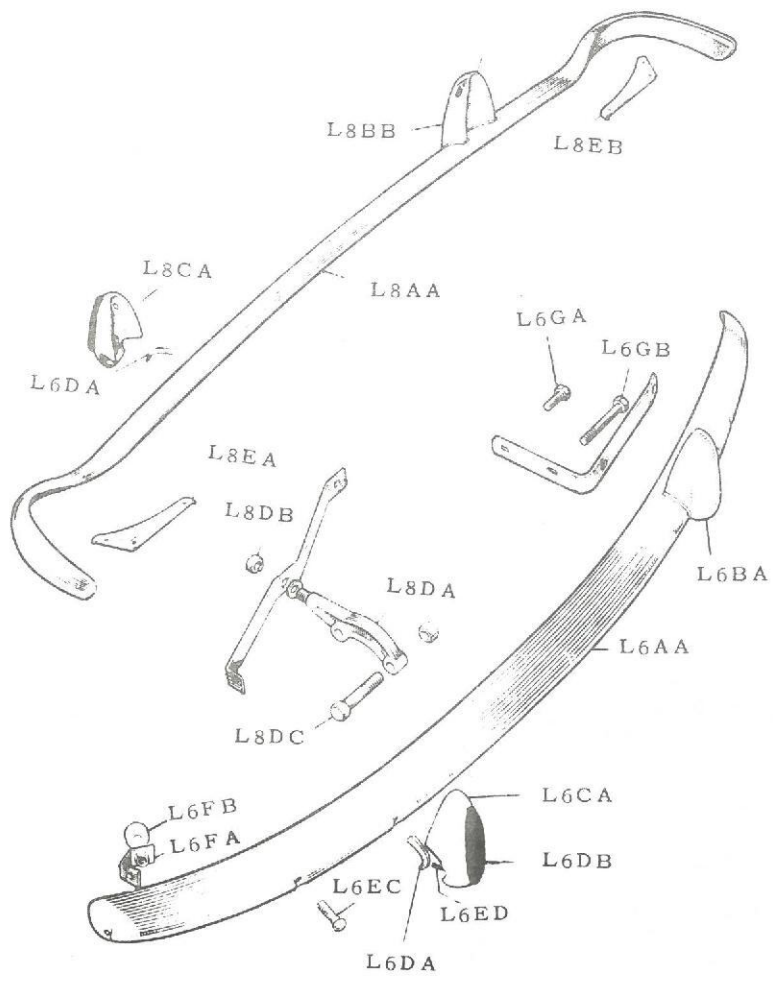

WINDSCREEN, WINDSCREEN WASHER & MIRRORS

WINDSCREENS ETC.

M4A A Windscreen Assy.—Roadster

M6A A Windscreen—Roadster

M6A B Glazing Seal—Roadster

M6B A Seal—Windscreen Pillar

M6B B Seal—Windscreen to Body

M6B C Seal—Pillar Foot—RH

M6B D Seal—Pillar Foot—LH

M8A A Windscreen—GT

M8A B Windscreen—Tinted—GT

M8A C Glazing Seal—GT

M8B A Glass—Tail Gate—GT

M8B B Glass—Tailgate—Heated—GT

M8B C Glass—Tailgate—Heated—Tinted—GT

M8B D Glazing Seal—GT

M8C A Rear Quarter Light Assembly—RH

M8C B Rear Quarter Light Assembly—LH

M8C C Rear Quarter Light Assembly—Tinted—RH

M8C D Rear Quarter Light Assembly—Tinted—LH

WINDSCREEN WASHER

M12A A Windscreen Washer Bag

M12B A Line Valve

M12B B Tubing— 4.8mm O.D.

M12B C Tubing— 6.4mm O.D.

M12C A W/Washer Jet—Roadster

M12C B W/Washer Jet—GT

M12C C T—Piece

M12D A W/Washer Electric Pump Kit

M12D B W/Washer Electric Pump

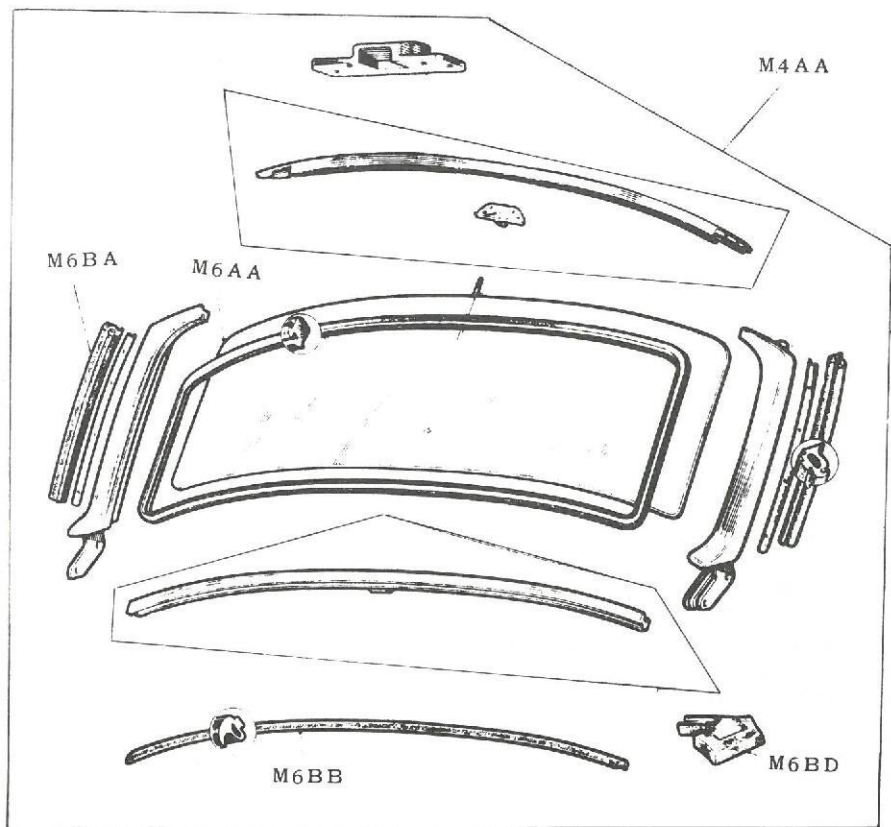

MIRRORS

M18AA Door Mirror-Flat-Glass-Tinted-RH

M18AB Door Mirror-Flat-Glass-Tinted-LH

M18BA Door Mirror-Flat Glass-RH

M18BB Door Mirror-Flat-Glass-LH

M18CA Door Mirror-Non-Genuine

M18DA Interior Mirrors

INTERIOR TRIMMING

FASCIA & CONSOLE

N4AA Blanking Plate—Radio (-76)
N4AB MG Motif (-76)
N4AC Bezel (-76)

N4BA Large Clip—Blanking Plate (-76)
N4BB Small Clip—Blanking Plate (-76)

N4CA Blanking Plate—Radio (76-)

N4DA Dashboard

N4EA Instrument Fascia (76-)

N8AA Radio Speaker Console (-73)
N8AB Radio Mounting Console (73-76)
N8AC Radio Mounting Console (76-)
N8AD Tunnel Mounted Console (73-)

N8BA Armrest - Centre Console
N8BB Striker—Armrest Fixing
N8BC Catch—Console Fixing

N8CA Ashtray - Console

N8DA Crash Pad - Dashboard Top

TRIM FIXINGS

O2AA Black Trim Panel Screws
O2AB Cup Washers

O2BA Metal Trim Clips

O2CA Plastic Trim Clips

O4AA Carpet Clips

DRAUGHT EXCLUDER

O6AA Dr.Excl.Capping-Roadster-Front-RH
O6AB Dr.Excl.Capping-Roadster-Front-LH
O6AC Dr.Excl.Capping-Roadster-Rear-RH
O6AD Dr.Excl.Capping-Roadster-Rear-LH

O6BA Door Dr.Excl.-Black-Furry
O6BB Door Dr.Excl.-Black-Plastic

O6CA Rear $\frac{1}{4}$ Light Dr. Excl.

DOOR TRIM (EXCLUDING LINERS)

010AA Door Capping (-65)
010AB Door Capping (65-68)
010AC Door Capping (68-)

010BA Capping Finisher-Roadster-Front-RH
010BB Capping Finisher-Roadster-Front-LH
010BD Capping Finisher-Roadster-Rear-LH

010CA Capping Finisher-GT-Front-RH
010CB Capping Finisher-GT-Front-LH
010CC Capping Finisher-GT-Rear-RH
010CD Capping Finisher-GT-Rear-LH

010DA Weatherstrip-Inner-Door Window-Roadster-RH
010DB Weatherstrip-Inner Door Window-Roadster-LH
010DC Weatherstrip-Inner Door Window-GT

012AA Armrest-Door Pull-Black
012AB Armrest-Door Pull-Autumn Leaf
012AC Armrest-Door Pull-Navy
012AD Armrest-Door Pull-Ochre

012BA Door Pull - Autumn Leaf
012BB Door Pull (-68) See J12BA
012BC Door Pull (68-72) See J12BB

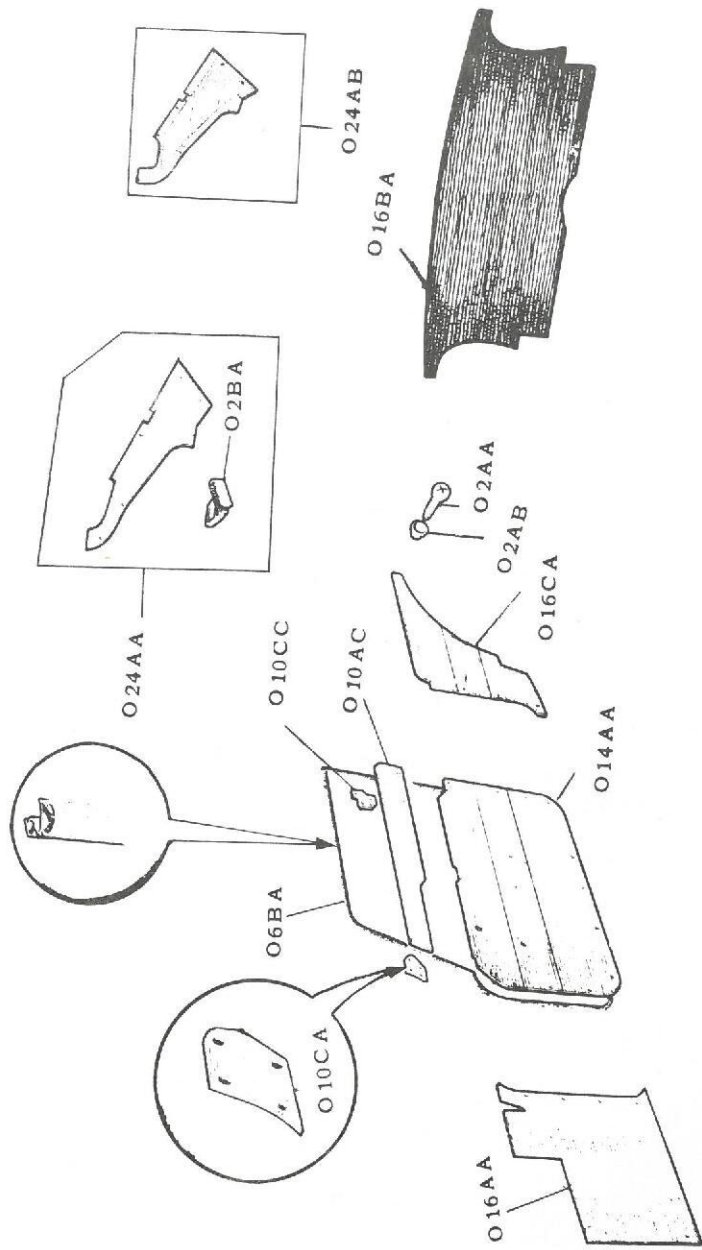

LINERS - BLACK

014AA Door Liner-RH (-68)
014AB Door Liner-LH (-68)

014BA Door Liner-RH (68-70)
014BB Door Liner-LH (68-70)

014CA Door Liner-RH (70-76)
014CB Door Liner-LH (70-76)

014DA Door Liner-RH(76-)
014DB Door Liner-LH (76-)

016AA Footwell Side Liner-RH
016AB Footwell Side Liner-LH

016BA Rear Bulkhead Liner-Roadster

016CA Rear Liner-RH (-70)
016CB Rear Liner - LH (-70)

016DA Rear Liner-Roadster-RH (70-)
016DB Rear Liner-Roadster-LH (70-)

016EA Rear Liner-GT-RH (70-)
016EB Rear Liner-GT-LH (70-)

LINERS-AUTUMN LEAF

018AA Door Liner-RH
018AB Door Liner-LH

018BA Footwell Side Liner-RH
018BB Footwell Side Liner-LH

018CA Rear Bulkhead Liner-Roadster

018DA Rear Liner-Roadster-RH
018DB Rear Liner-Roadster-LH

018EA Rear Liner-GT-RH
018EB Rear Liner-GT-LH

LINERS-NAVY BLUE

O20AA Door Liner-RH

O20AB Door Liner-LH

O20BA Footwell Side Liner-RH

O20BB Footwell Side Liner-LH

O20CA Rear Bulkhead Liner-Roadster

O20DA Rear Liner-RH

O20DB Rear Liner-LH

LINERS-YELLOW OCHRE

O22AA Door Liner-RH

O22AB Door Liner-LH

O22BA Footwell Side Liner-RH

O22BB Footwell Side Liner-LH

O22CA Rear Bulkhead Liner-Roadster

O22DA Rear Liner-RH

O22DB Rear Liner-LH

LINERS-OTHERS

O24AA Rear Side Liner-Grey(Tailgate Opening)-RH

O24AB Rear Side Liner-Grey (Tailgate Opening)-LH

CARPETS & MATS-BLACK

O30AA Rubber Mat-Front-RH
O30AB Rubber Mat-Front-LH

O30BA Carpet-Front-RH
O30BB Carpet-Front-LH

O30CA Rubber Mat-Rear-RH
O30CB Rubber Mat-Rear-LH

O30DA Carpet-Rear-RH
O30DB Carpet-Rear-LH

O30EA Rubber Mat-Sill-RH
O30EB Rubber Mat-Sill-LH

O30FA Carpet-Sill-RH
O30FB Carpet-Sill-LH

O30GA Tunnel Carpet (-68)
O30GB Tunnel Carpet (68-72)
O30GC Tunnel Carpet (72-)

O30HA Carpet-Heelboard

O30JA Carpet-Battery Cover

O30KA Carpet-Spare Wheel Cover-GT

O30LA Carpet Set-Roadster (-68)
O30LB Carpet Set-Roadster (68-72)
O30LC Carpet Set-Roadster (72-)

O30MA Carpet Set-GT (-68)
O30MB Carpet Set-GT (68-72)
O30MC Carpet Set-GT (72-)

O30NA Carpet-Rubber Backed-Off The Roll
O30NB Carpet-Felt Backed-Off The Roll

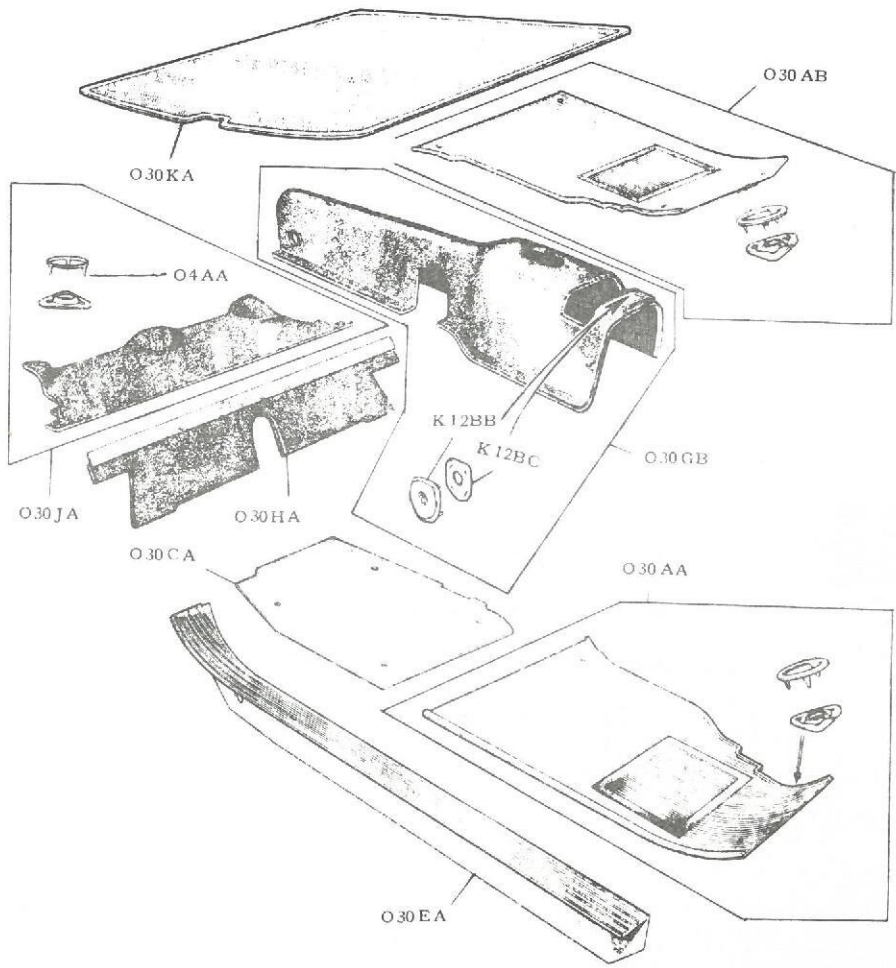

CARPETS & MATS-RED

O32AA Tunnel Carpet (-68)

O32BA Carpet Set-Roadster (-68)

O32BB Carpet Set-GT (-68)

O32CA Carpet-Rubber Backed-Off The Roll

CARPETS & MATS-AUTUMN LEAF

O34AA Rubber Mat-Front-RH

O34AB Rubber Mat-Front-LH

O34BA Rubber Mat-Sill-RH

O34BB Rubber Mat-Sill-LH

O34CA Tunnel Carpet

O34DA Carpet-Spare Wheel Cover-GT

O34EA Carpet Set-Roadster

O34EB Carpet Set-GT

O34FA Carpet-Rubber Backed-Off The Roll

CARPETS & MATS-NAVY BLUE

O36AA Tunnel Carpet

O36BA Carpet Set-Roadster

O36BB Carpet Set-GT

O36CA Carpet-Rubber Backed-Off The Roll

CARPETS & MATS-YELLOW OCHRE

O38AA Rubber Mat-Front-RH

O38AB Rubber Mat-Front-LH

O38BA Tunnel Carpet

O38CA Carpet-Off The Roll

SEATS, BELTS & HEADRESTS

O50AA Seats-Non Reclining

O50AB Seats-Reclining

O52AA Seat Covers

O54AA Headrest-Black (-76)

O54AB Headrest-Autumn Leaf (-76)

O54AC Headrest-Navy Blue (-76)

O54AD Headrest-Ochre (-76)

O54BA Headrest-Black (76-)

O58AA Seat Belt Kit

O58AB Seat Belt Kit- Retractable

O58AC Full Harness

O58BA Cover-Seat Belt Parking

WHEELS & TOWBAR

WHEELS

P2AA Rostyle Wheel—Stove Enamel

P2AB Rostyle Wheel—Chrome

P2BA Wheel—V8

P2CA Wire Wheel—Stove Enamel

P2CB Wire Wheel—Chrome

P2DA Wire Wheel—MGC

WHEEL ACCESSORIES ETC.

P4AA Rostyle Centre Cap

P4AB Rostyle Motif—Silver

P4AC Rostyle Motif—Gold

P4BA Centre Cap—V8

P4BB Centre Cap—Gold—V8

P4CA Rostyle Wheel Nuts

P4DA Wheel Nuts—V8

P4EA Eared Spinner—W/W—RH

P4EB Eared Spinner—W/W—LH

P4FA Hexagon Spinner—W/W—RH

P4FB Hexagon Spinner—W/W—LH

P4GA Spanner—Disc Wheels

P4GB Spanner—Rostyle Wheels

P4GC Spanner—Wire Wheels

P4HA Wire Wheel Cleaning Brush

P4JA Spacer (For Changing From Wires To Rostyles)

P4JB Stud—Long—Rear

TOWBAR

Q2AA Towbar(-75)

Q2AB Towbar(75-)

Q2BA Tow Ball

Q2CA Socket-7-Pin

Q2CB Plug-7-Pin

Q2CC Socket Fixing Plate

Q2DA Cable-7-Core

LITERATURE & ACCESSORIES

LITERATURE

- R2AA Workshop Manual-BL-MGB (-77)
- R2AB Workshop Manual-BL-MGB (78-)

- R2BA Workshop Manual-BL-V8 Supplement

- R2CA Workshop Manual-Haynes-MGB (-77)

- R2DA Workshop Manual-MGC

- R2EA Manual-SU Carbs

- R2FA Special Tuning Booklet

- R4AA Parts Manual (-76)
- R4AB Parts Manual (76-)

- R4BA Parts Manual-MGC

- R6AA MGB Handbook (-70)
- R6AB MGB Handbook (70-76)
- R6AC MGB Handbook (76-)

- R6BA V8 Handbook

- R6CA MGC Handbook

PAINT

- S2 Touch-Up-Paint-Brushing (State Colour)

- S4 Touch-Up-Paint-Spray (State Colour)

- S6AA Engine Paint-Red
- S6AB Engine Paint-Black

ACCESSORIES

- S10AA Keyfobs-Black
- S10AB Keyfobs-Tan

- S10BA MG Sew-On Patch

- S10CA MGB Roadster Copper Framed Etching
- S10CB MGB GT Copper Framed Etching

- S20AA Boot Rack

INFORMATION

In general, the parts apply to MGB 1798cc 5-bearing engine cars, unless otherwise stated, although if separate parts are not listed for V8 & MGC it can usually usually be assumed that they are the same as normal MGB

This is not a complete list of our stock, there are many parts, mainly, secondhand and nuts, bolts, screws, clips, washers, and new stock which are not contained in this catalogue, so if in doubt please ask.

If there are any parts which you require which we do not stock, we shall be pleased to try and obtain them, on receipt of a deposit, which will be refunded if we cannot supply.

Postal Service

Parts can be ordered by telephone or letter. We will require payment before despatch of goods
For carriage charges see our current price list, or telephone us direct.

Hours of Business

MONDAY TO FRIDAY	9am to 6pm
SATURDAY	9am to 4pm
SUNDAY	CLOSED

ABBREVIATIONS.

A/Roll	Anti-Roll
Carb	Carburettor
Cyl.	Cylinder
Dr.	Draught
Eng.	Engine
F or FR	Front
G/Box	Gearbox
LH	Left (Passenger) Side
Man.	Manifold
Mot.	Motion
MTG.	Mounting
M/CYL	Master Cylinder
No.	Number
O/D	Overdrive
O.D.	Outside Diameter
RH	Right (Driver's) Side
STD	Standard
W	Window or Windscreen
(-'75)	Fitted Prior to & Including 1975
('72-)	Fitted After & Incl. 1972
('68-76)	Fitted Between These Years

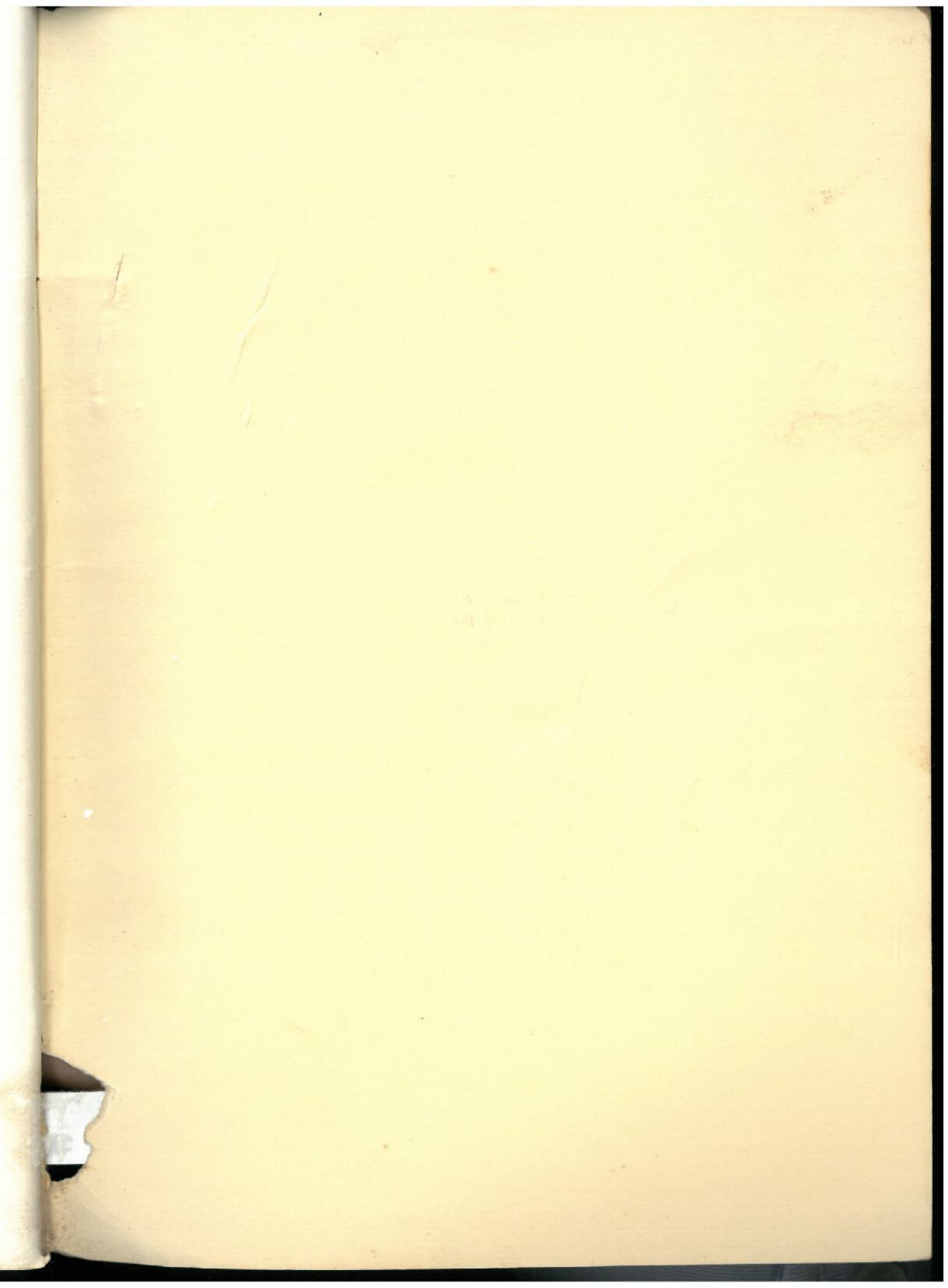

22

Sys. nr